



**sistemas
continental**
aluminio para arquitectura

SC 80-87 RPT



QUALICOAT
| SEASIDE | QUALIDECO |

af **aluminios
franco**

TRANSMITANCIA TERMICA SC. 80 RPT

- Marco ventana / Hoja ventana.

- Marco puerta / Hoja puerta.

- Sin espumas -

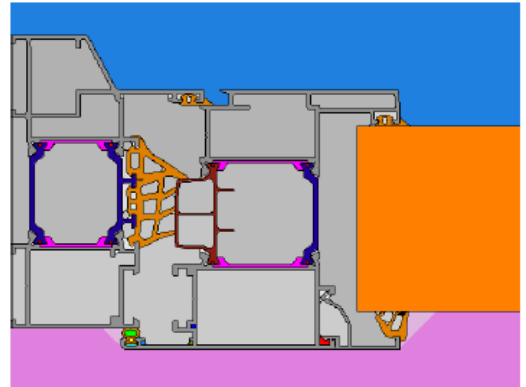
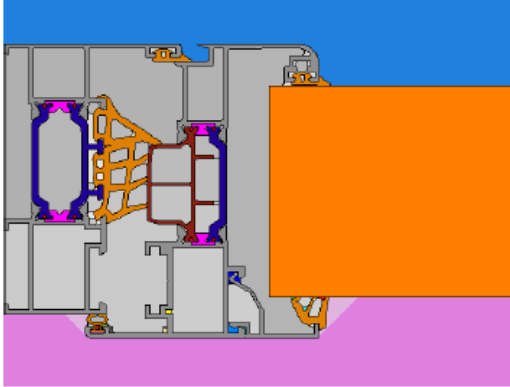

Uf Marco: 2.2 W/m2K

Uf Marco: 2.2 W/m2K

- Espumas 0.035 W/mK en galce de vidrio y marco -

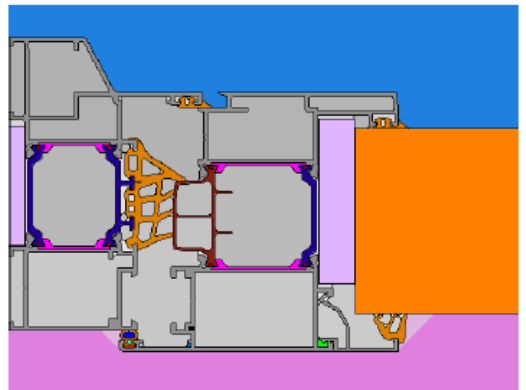
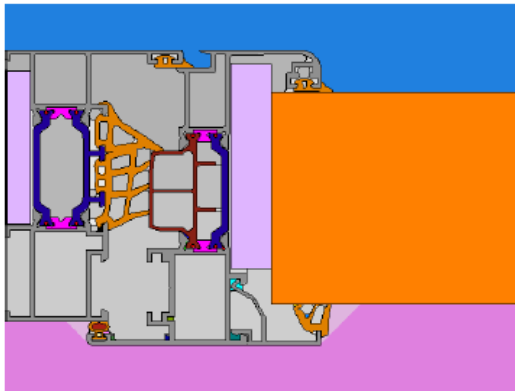

Uf Marco: 1.9 W/m2K

Uf Marco: 1.9 W/m2K

-Espumas 0.035 W/mkK en galce de vidrio, entre poliamidas y marco -

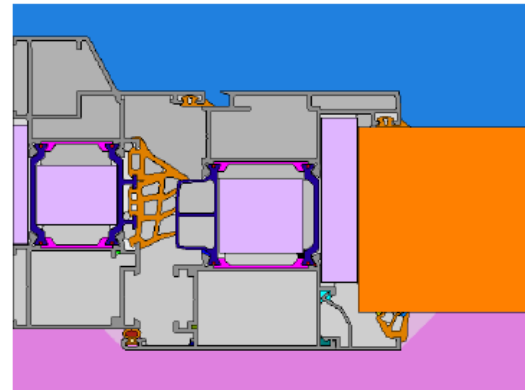
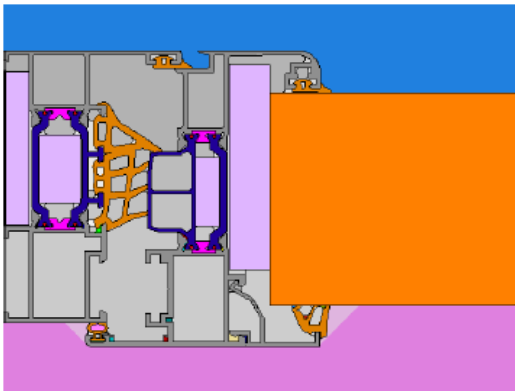

Uf Marco: 1.6 W/m2K

Uf Marco: 1.4 W/m2K

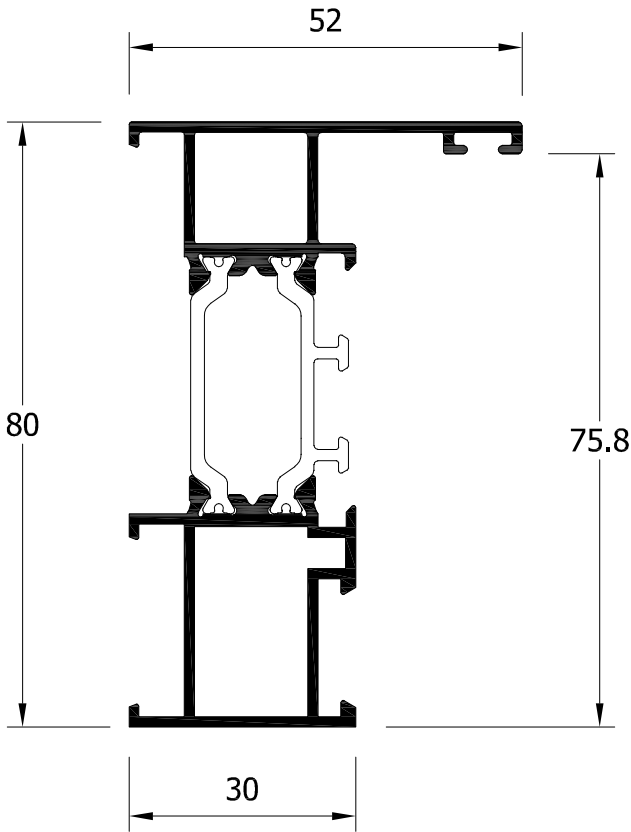

80181
Marco ventana

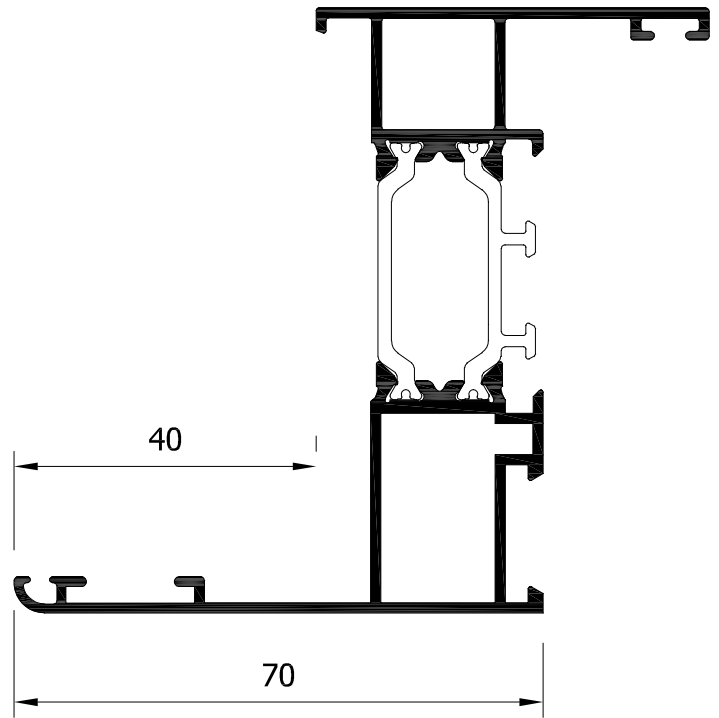

*** 80189**
Marco tapajuntas 40 mm

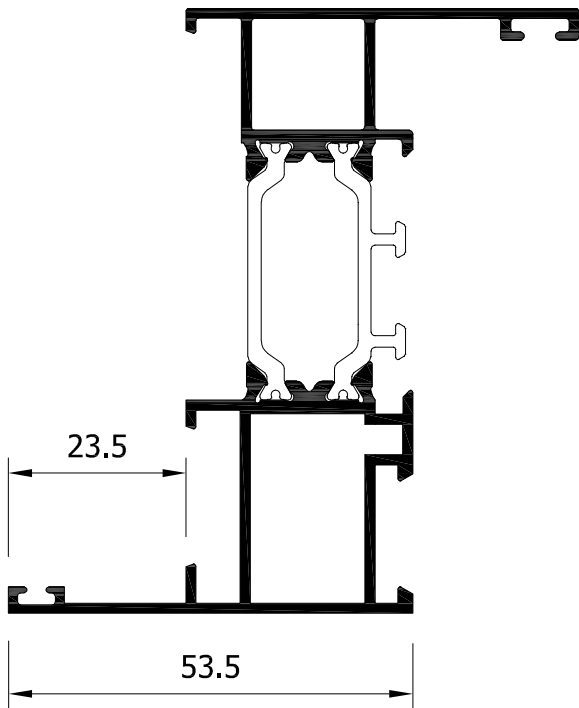

80187
Marco tapajuntas 23 mm

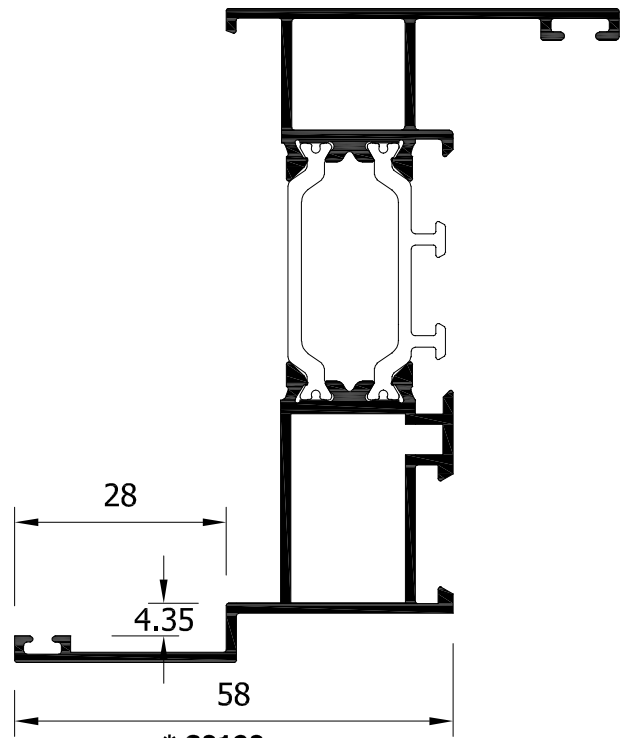

*** 80190**
Marco tapajuntas resalte.28 mm

* Marcos bajo consulta

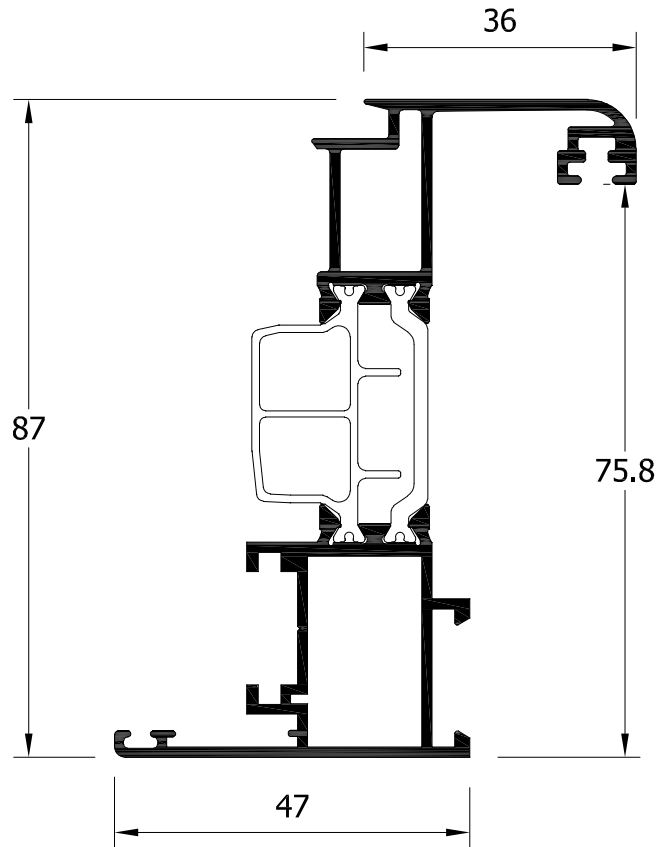

80183
Hoja ventana

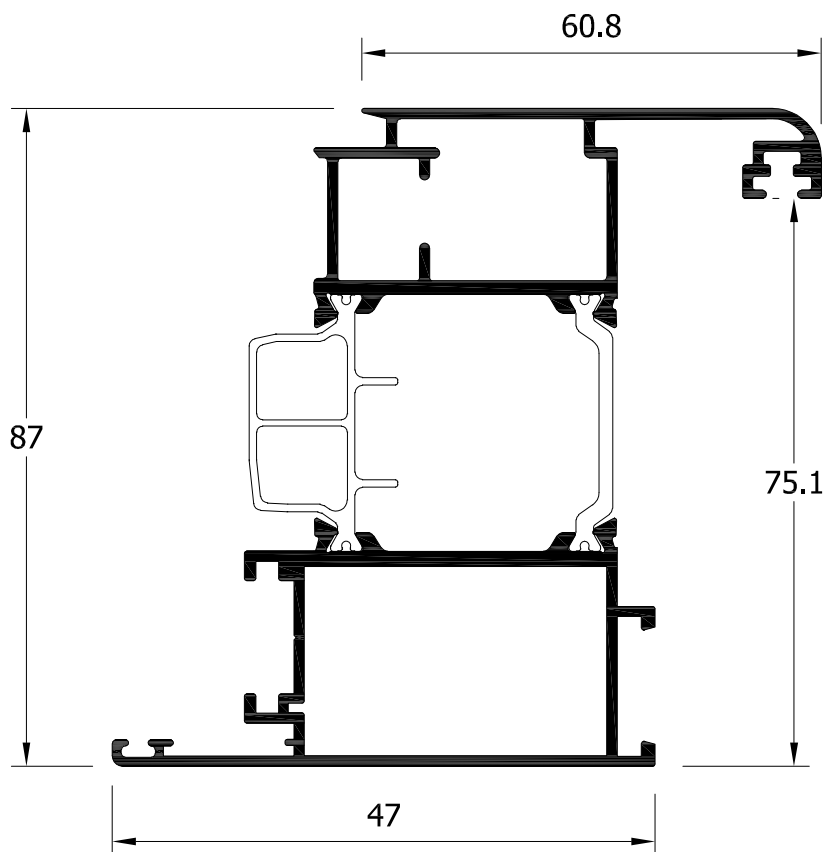

80184
Hoja puerta

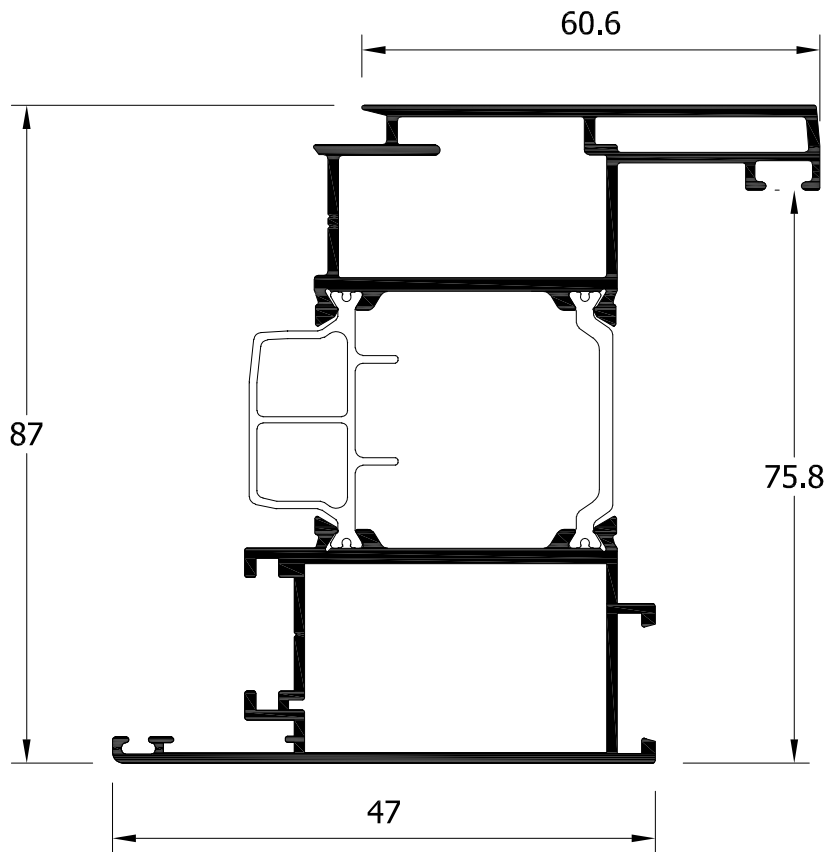

80193
Hoja puerta recta

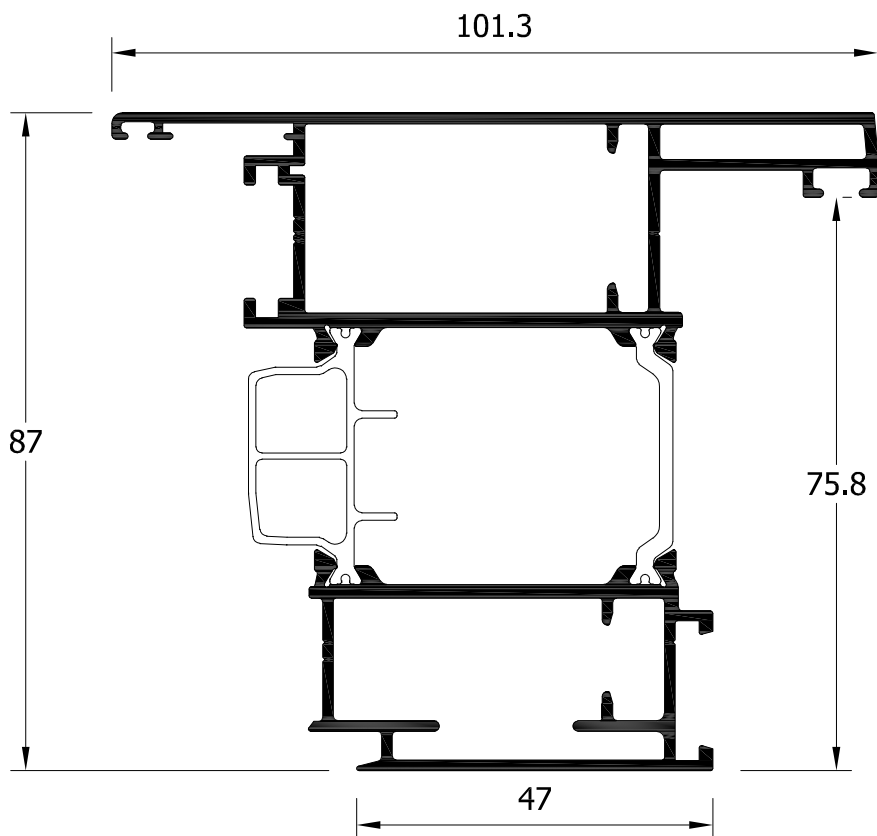

80192
Hoja puerta recta
Apertura exterior

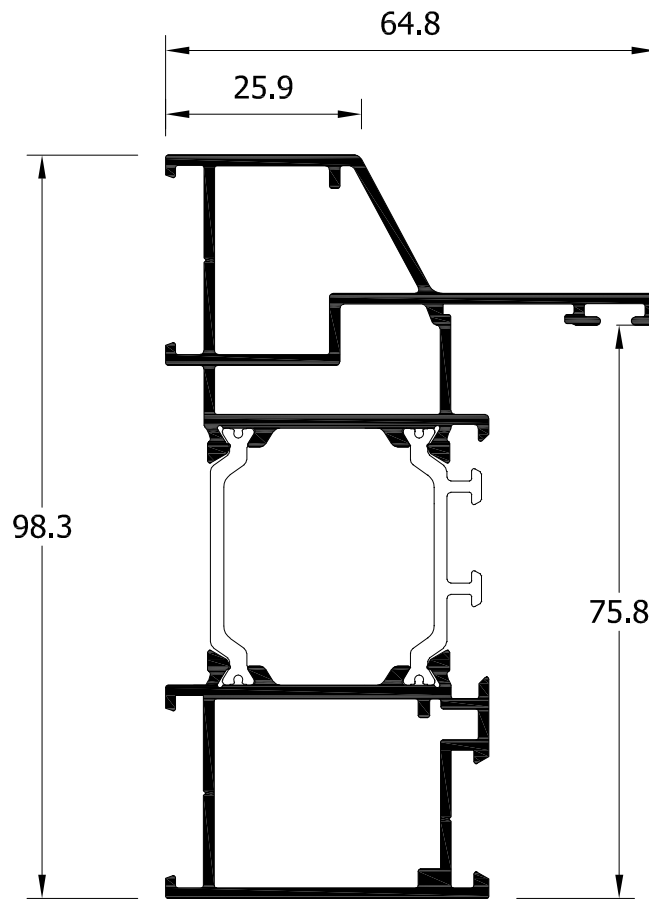

80191
Marco puerta escarparte

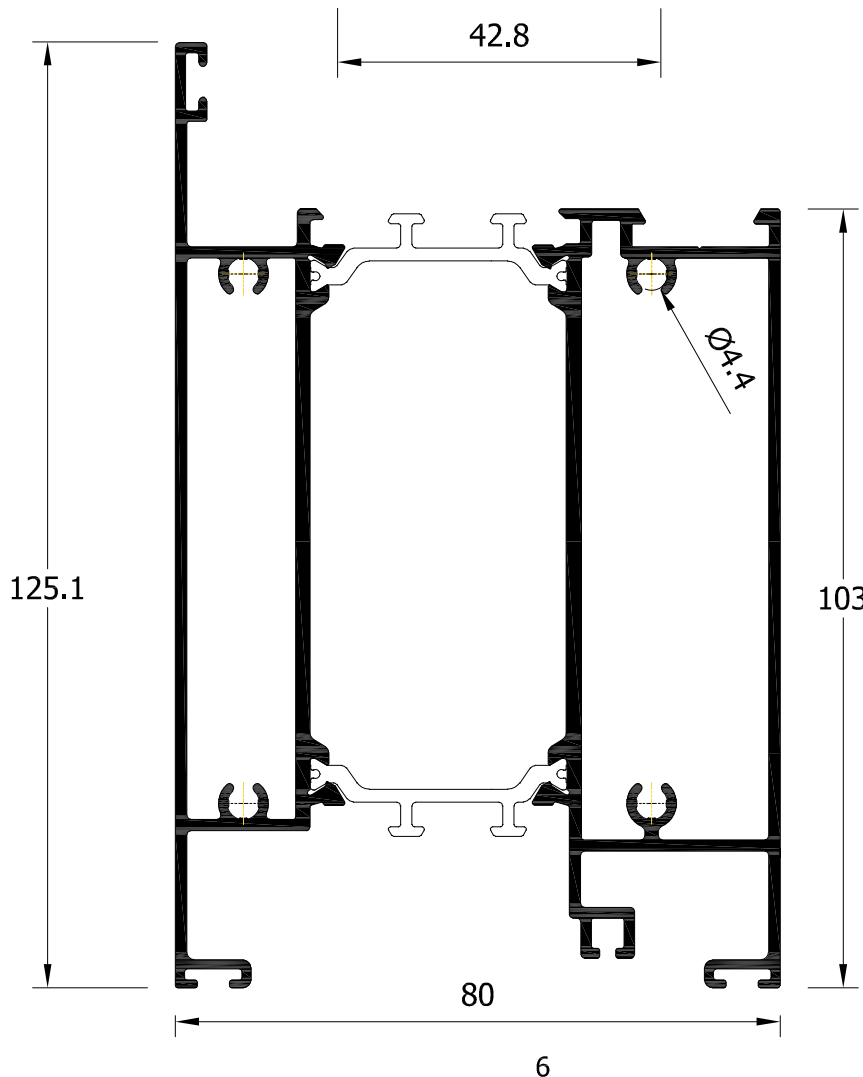

80194
Marco zocalo 125

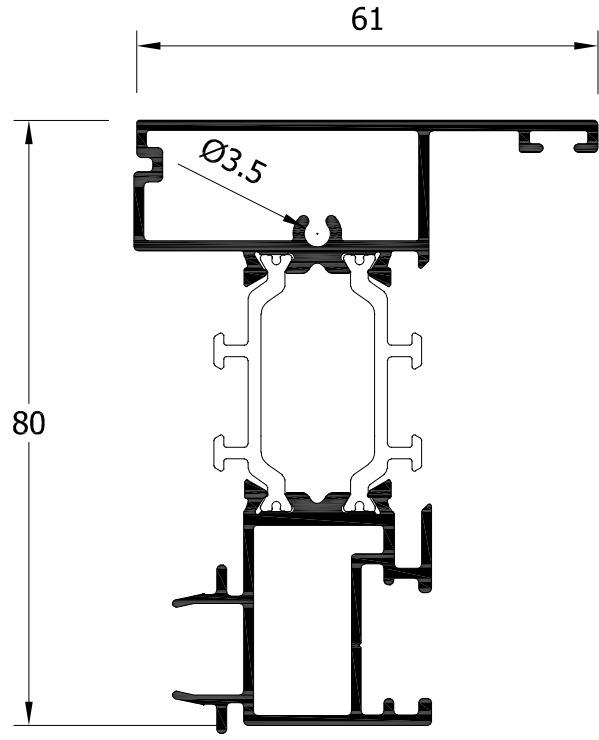

80188
Inversor

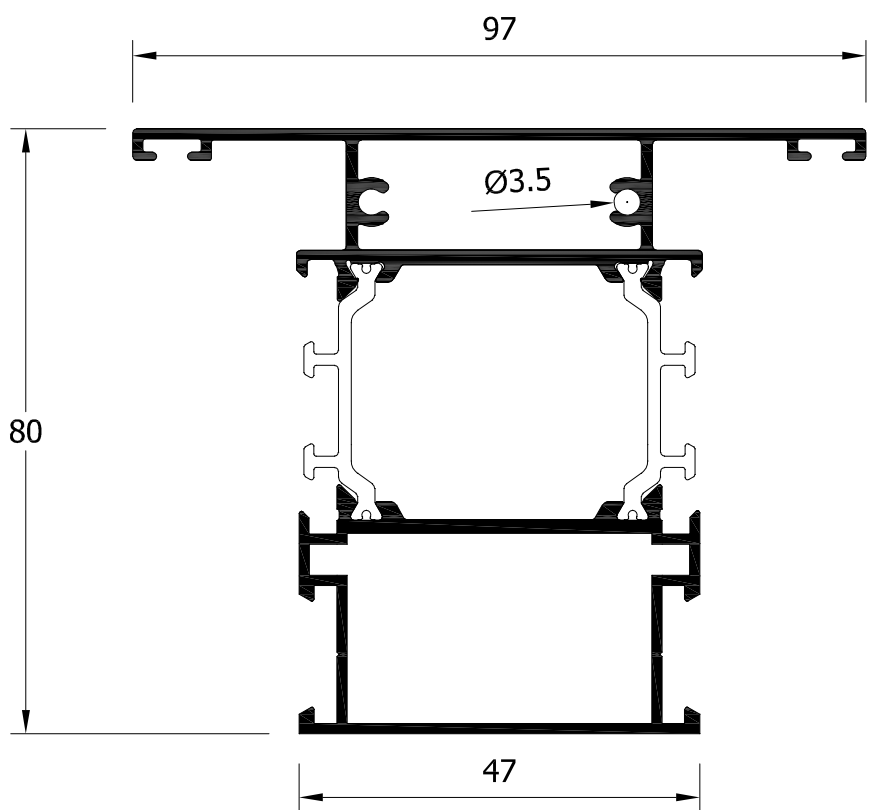

80186
Travesaño puerta



TABLA DE ACRISTALAMIENTO:

TABLA JUNQUILLOS HOJA Y FIJO - Huevo libre en mm

RECTOS	REFERENCIA	MEDIDA	EXA-80 RPT
	25015		32
	13023		44
	13007		49
	13034		54
	13016		58
	13006		62
	13025		68

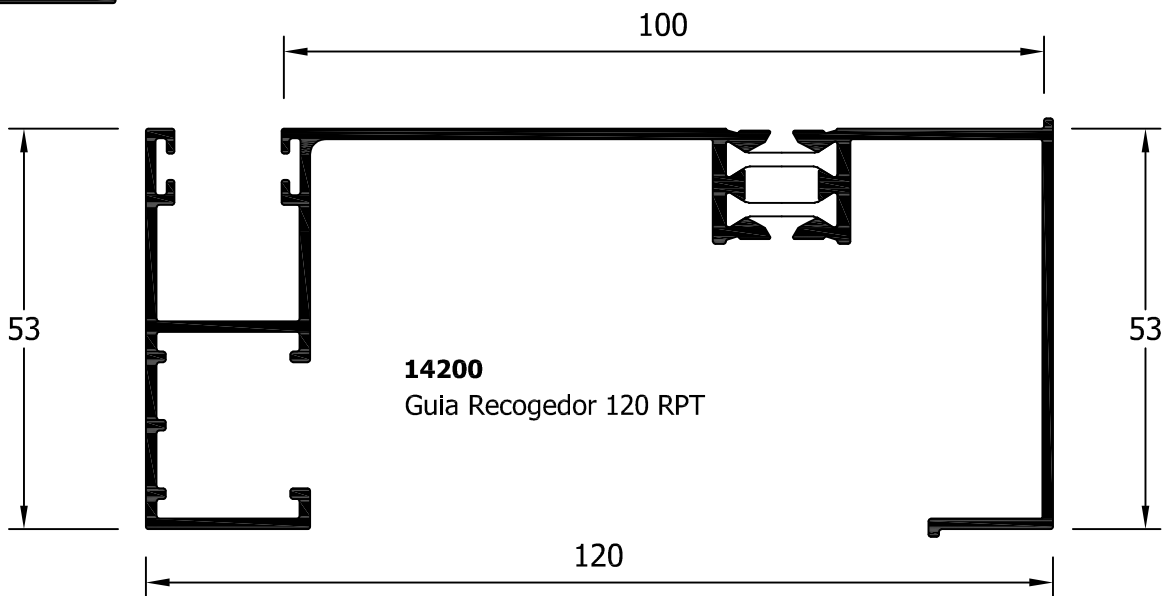
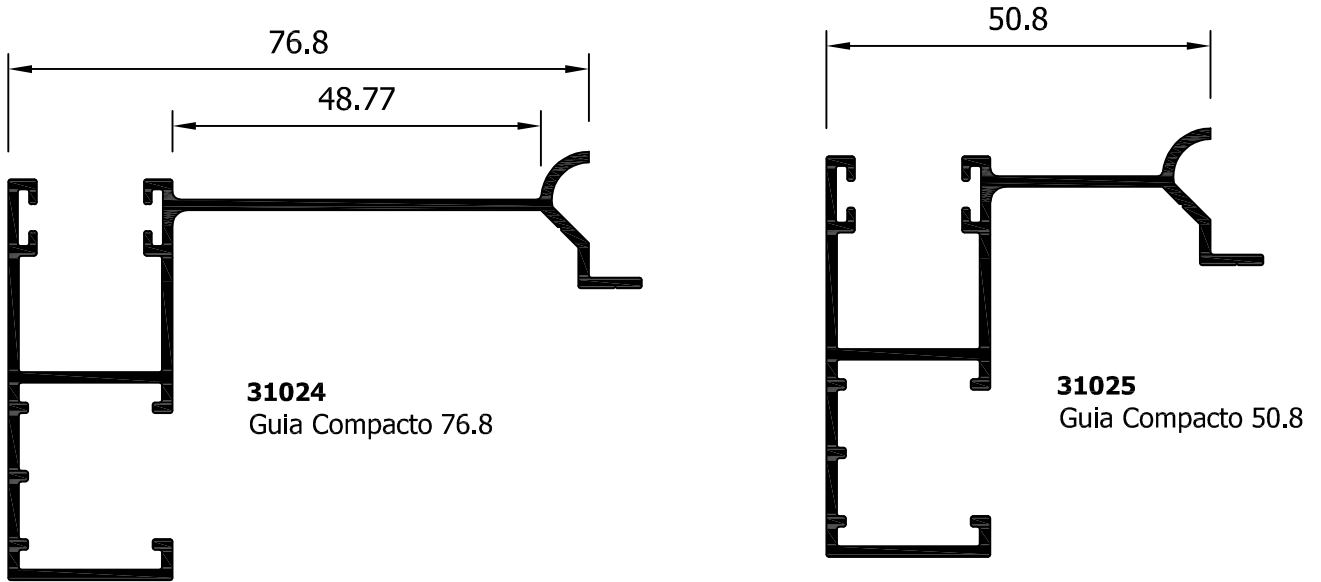
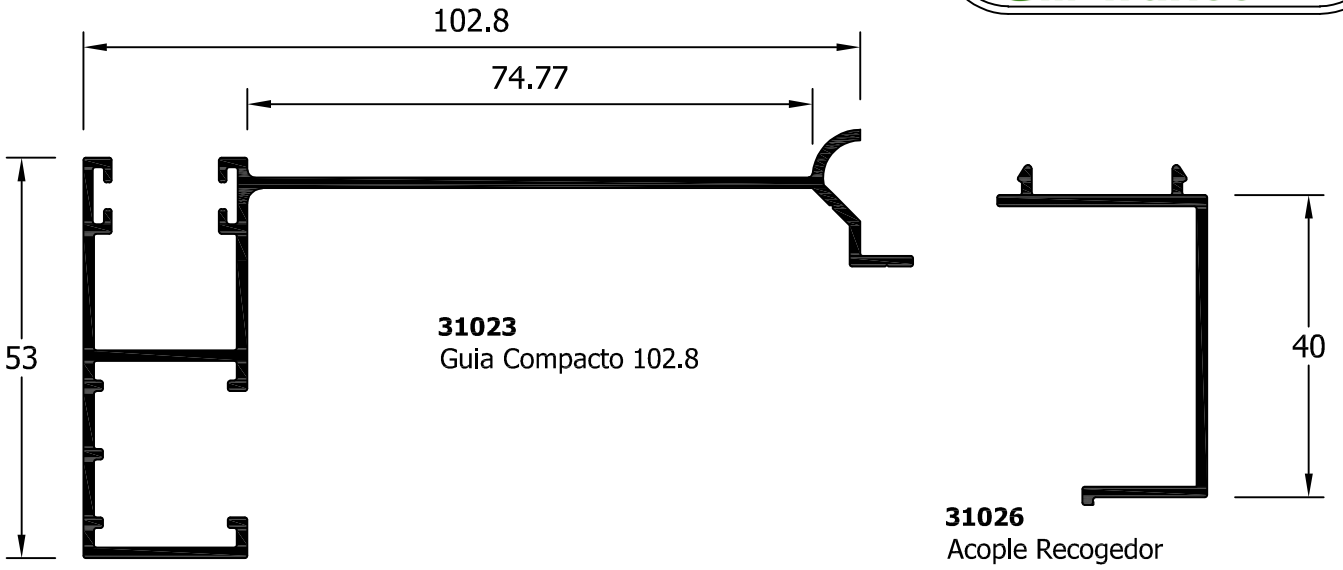
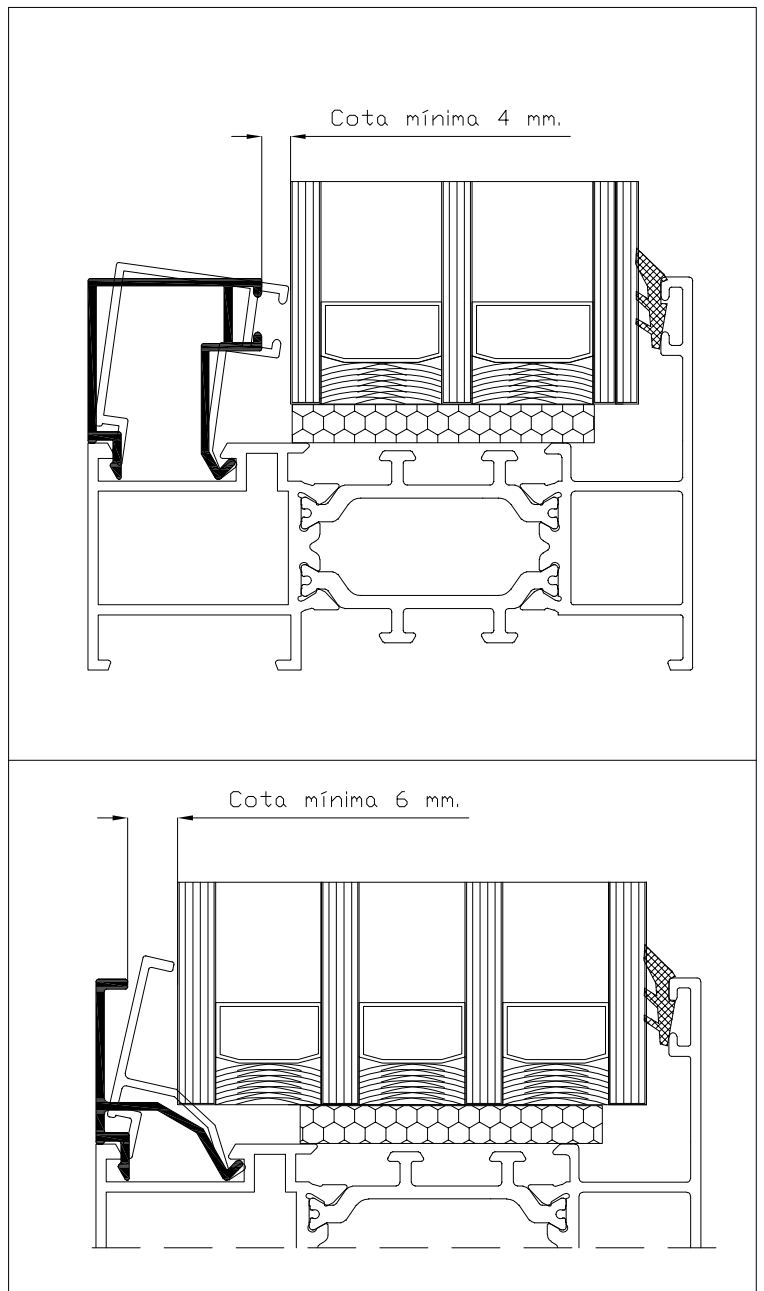

TAPAJUNTAS

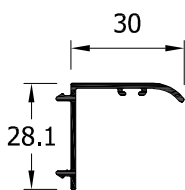

24007
Solape clipado 30 mm

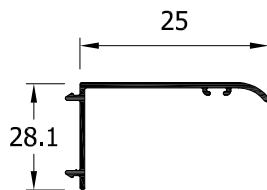

24008
Solape clipado 50 mm

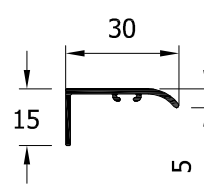

23011
Tapajuntas 30 s/clip

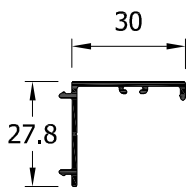

75160
Solape recto clipado 30 mm

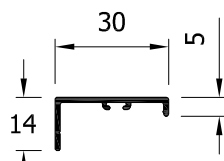

75161
Tapajuntas recto 30 s/clip

Escala 1:2

MARCO: **80181**
HOJA: **80183**

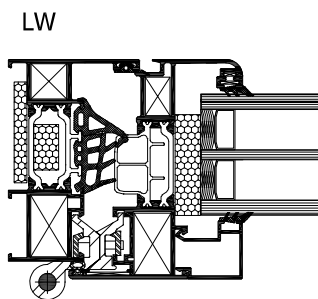
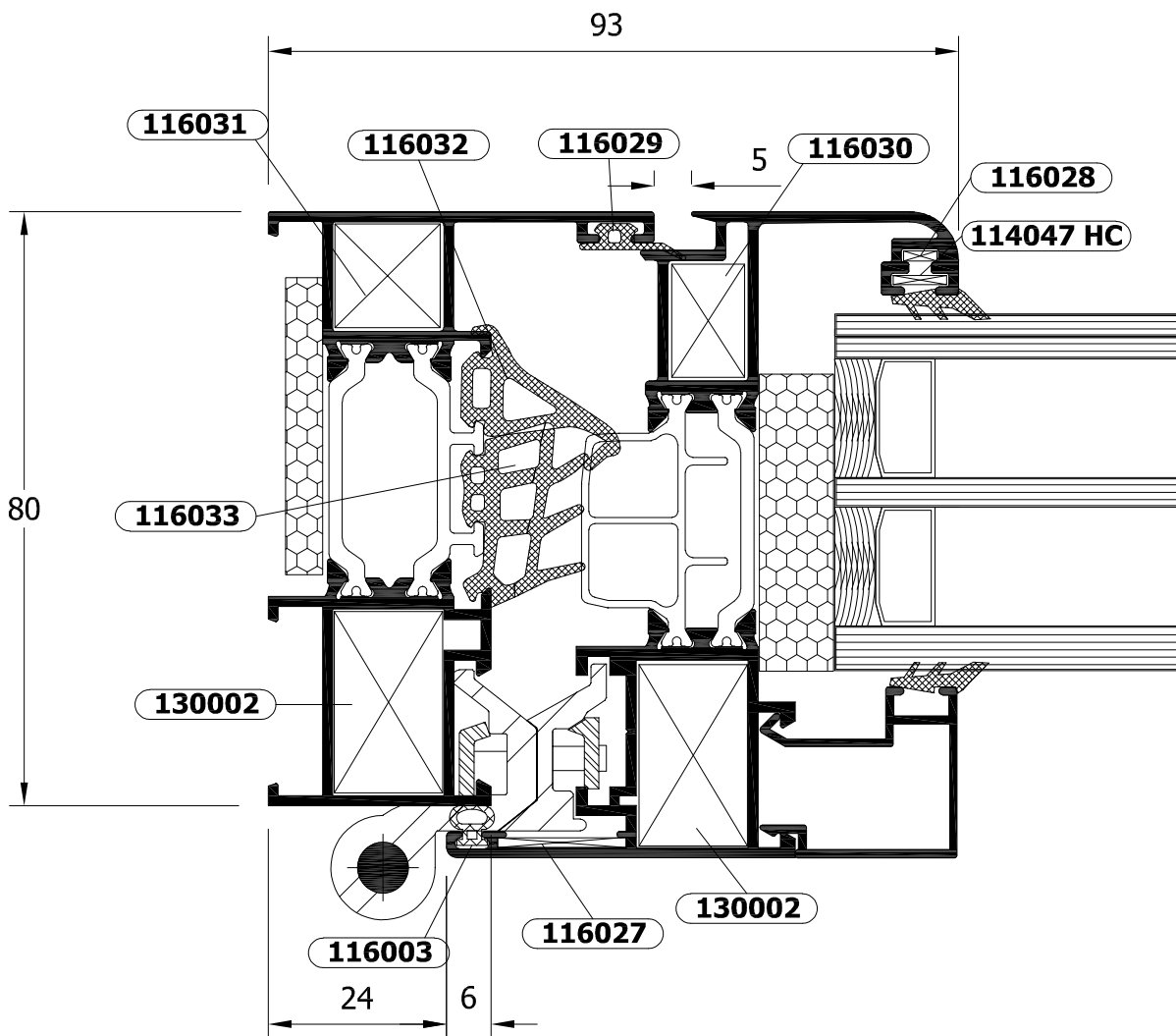
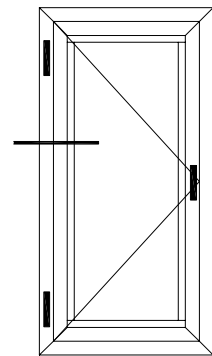

ESCALA 1:3

INVERSOR: **80188**
HOJA: **80183**

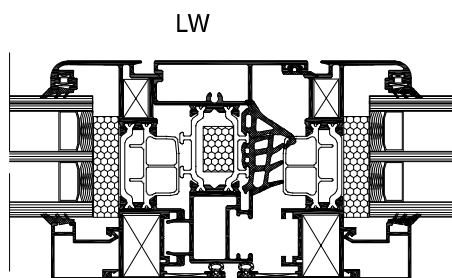
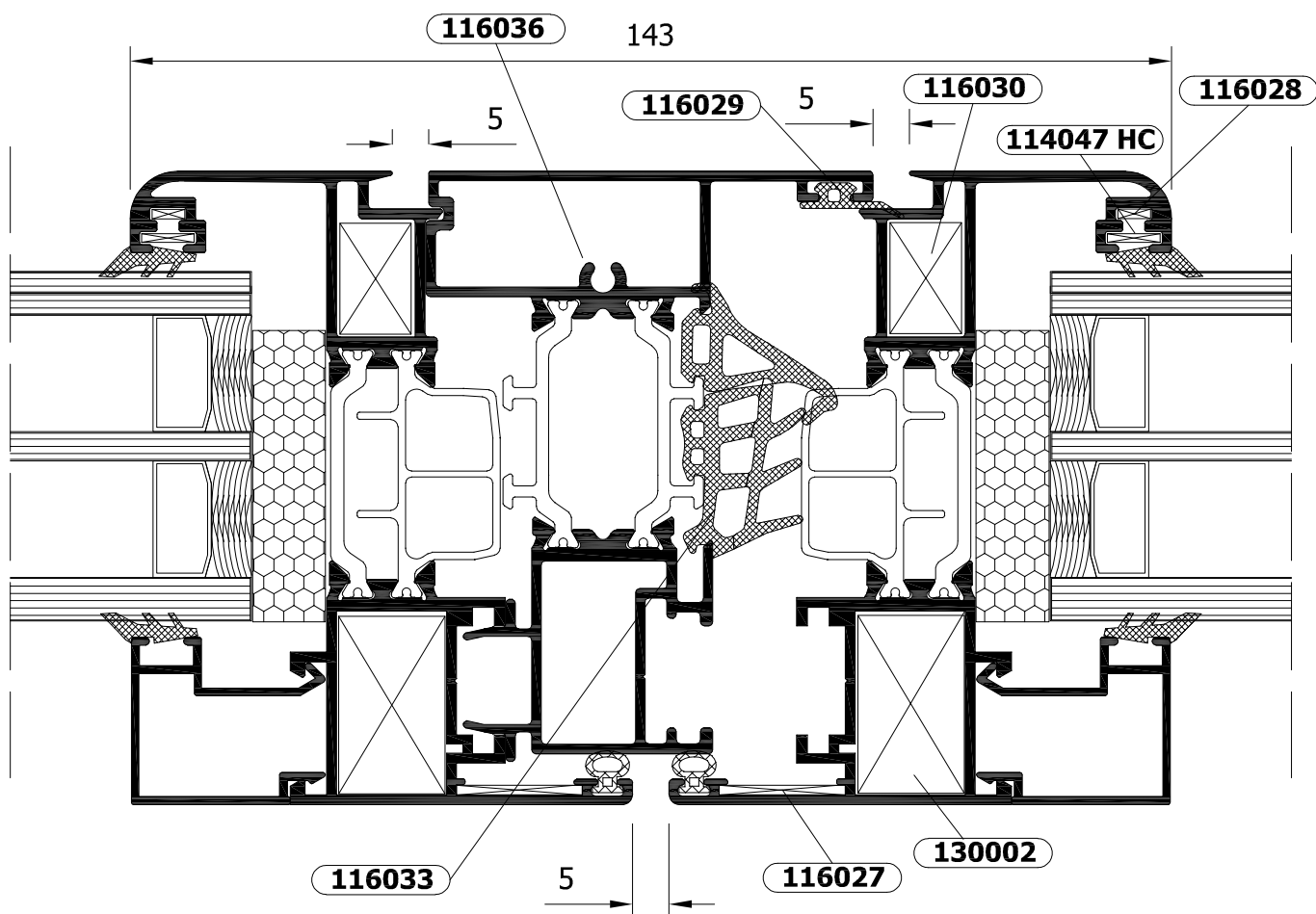
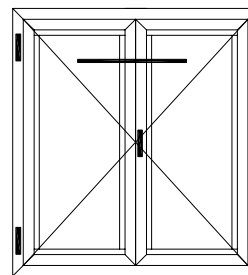

ESCALA 1:3

MARCO: **80181**
HOJA: **80184**

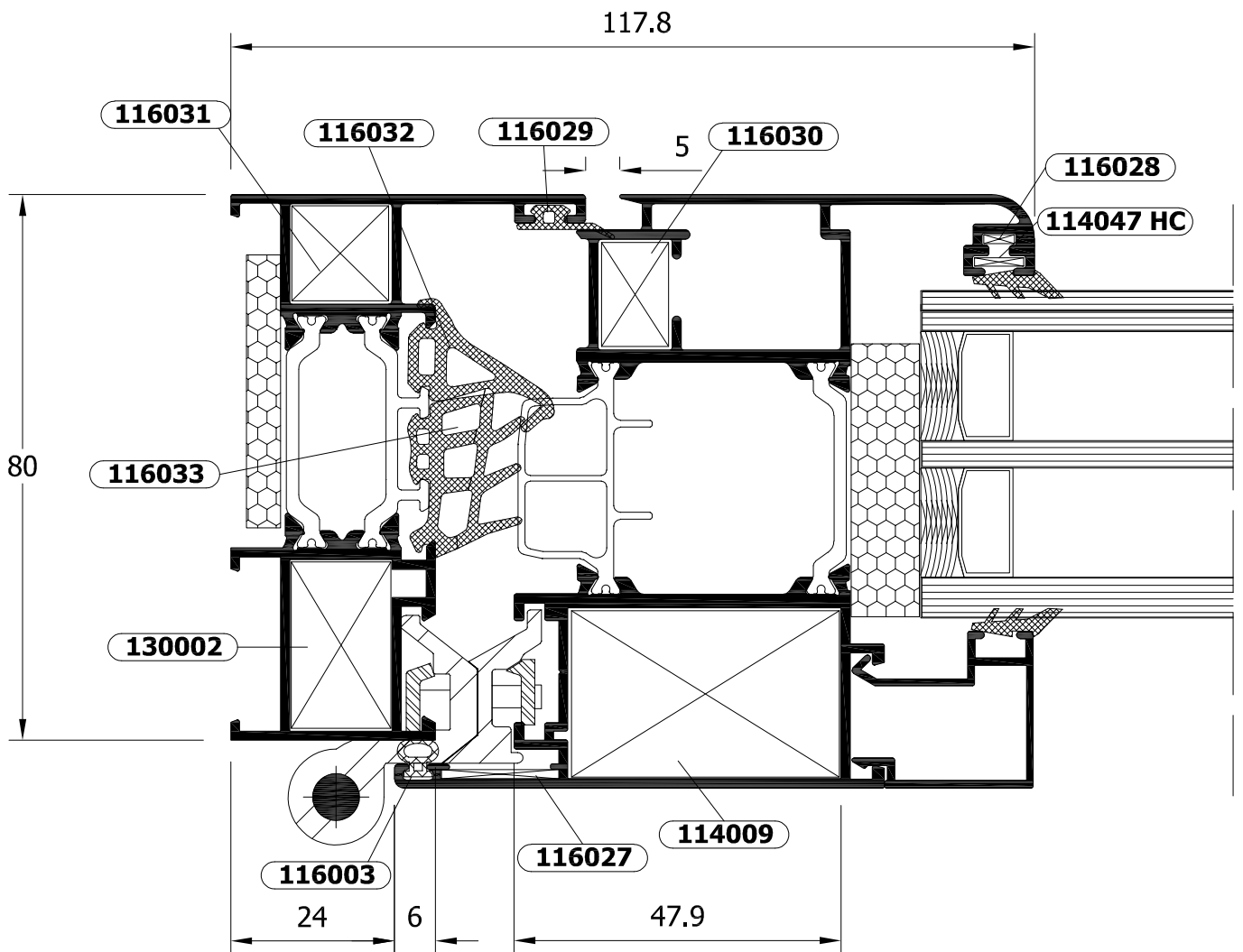
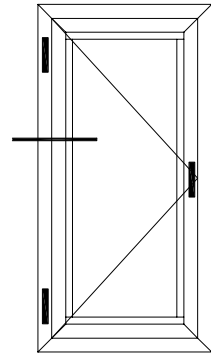

LW

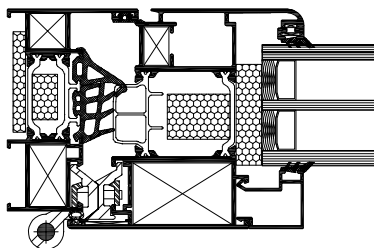

ESCALA 1:3

INVERSOR: **80188**
HOJA: **80184**

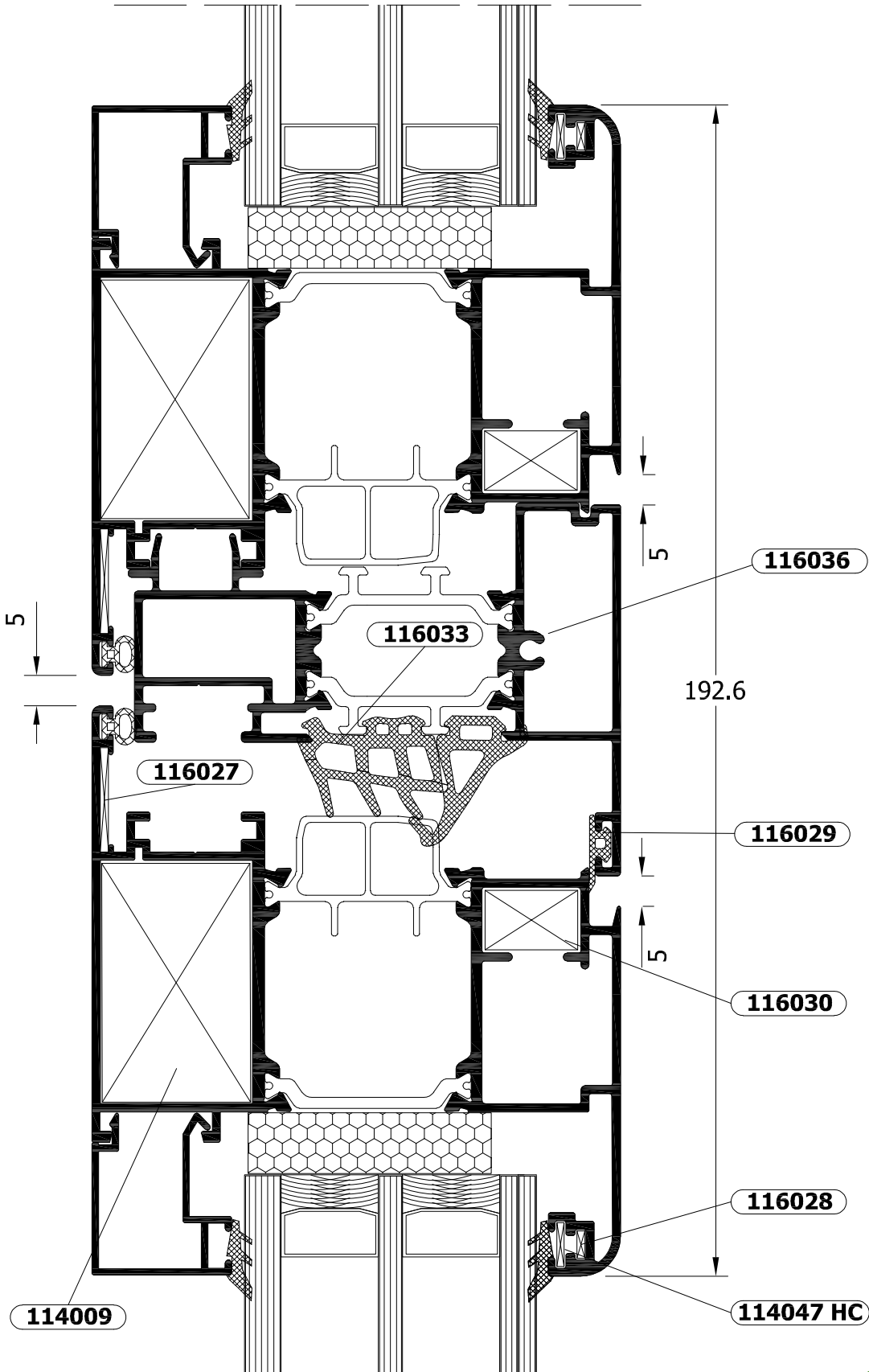
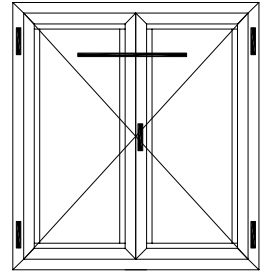

LW

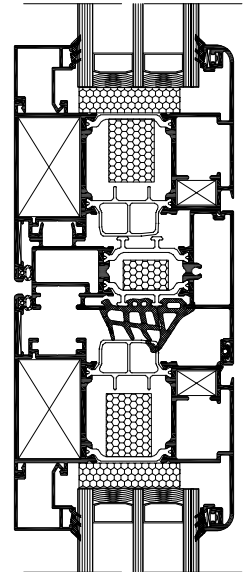

ESCALA 1:3

MARCO: **80191**
HOJA: **80183**

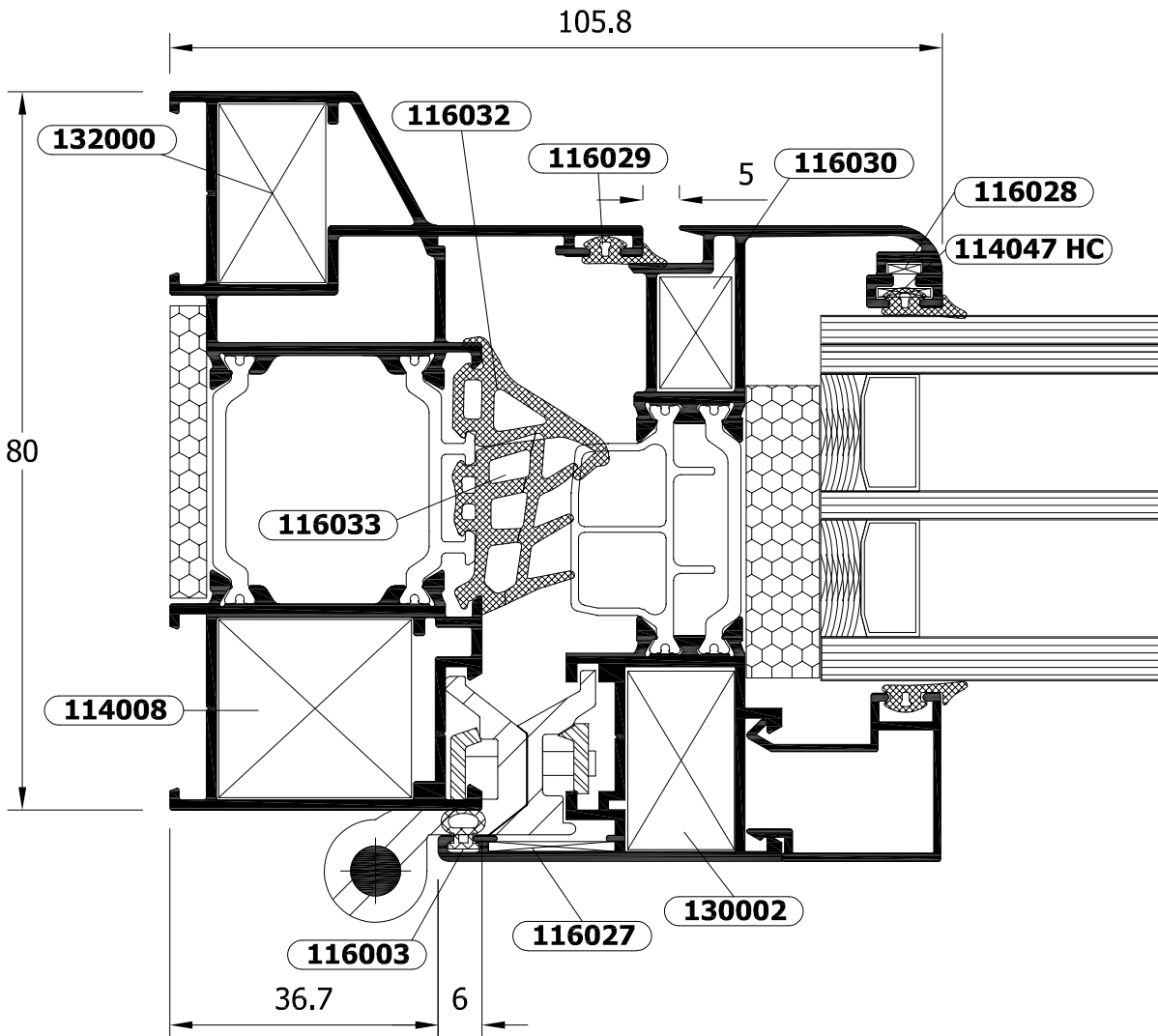
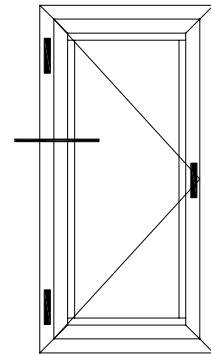

LW

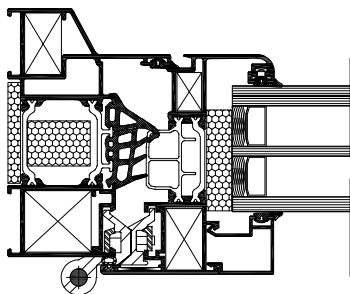

ESCALA 1:3

MARCO: **80191**
HOJA: **80193**

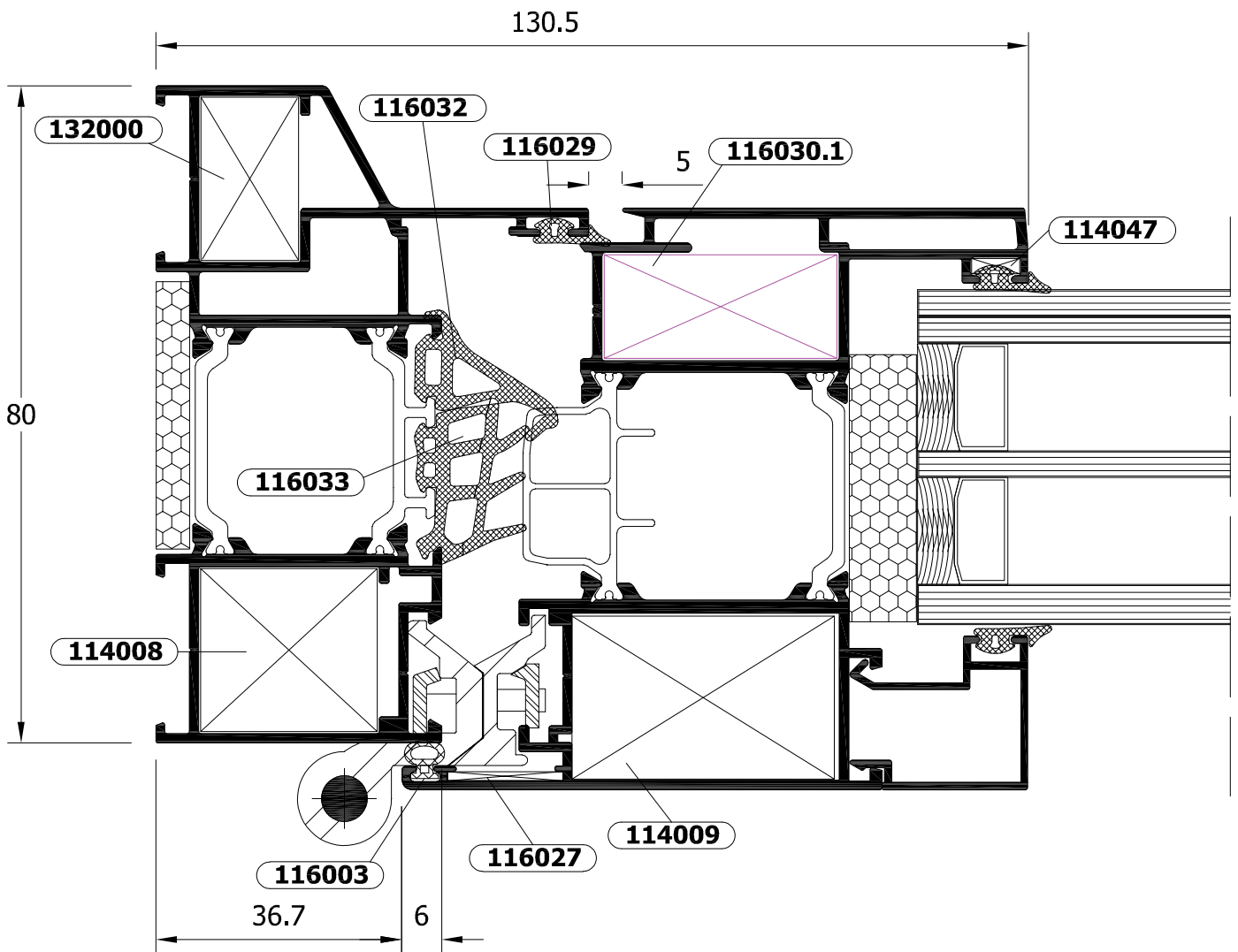
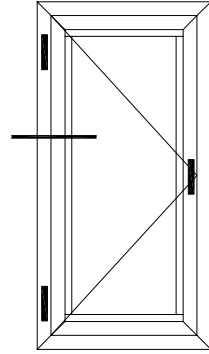

LW

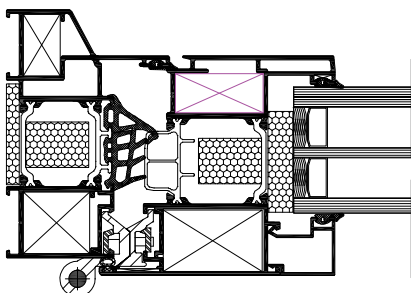

ESCALA 1:3

MARCO: 80191
HOJA: 80192

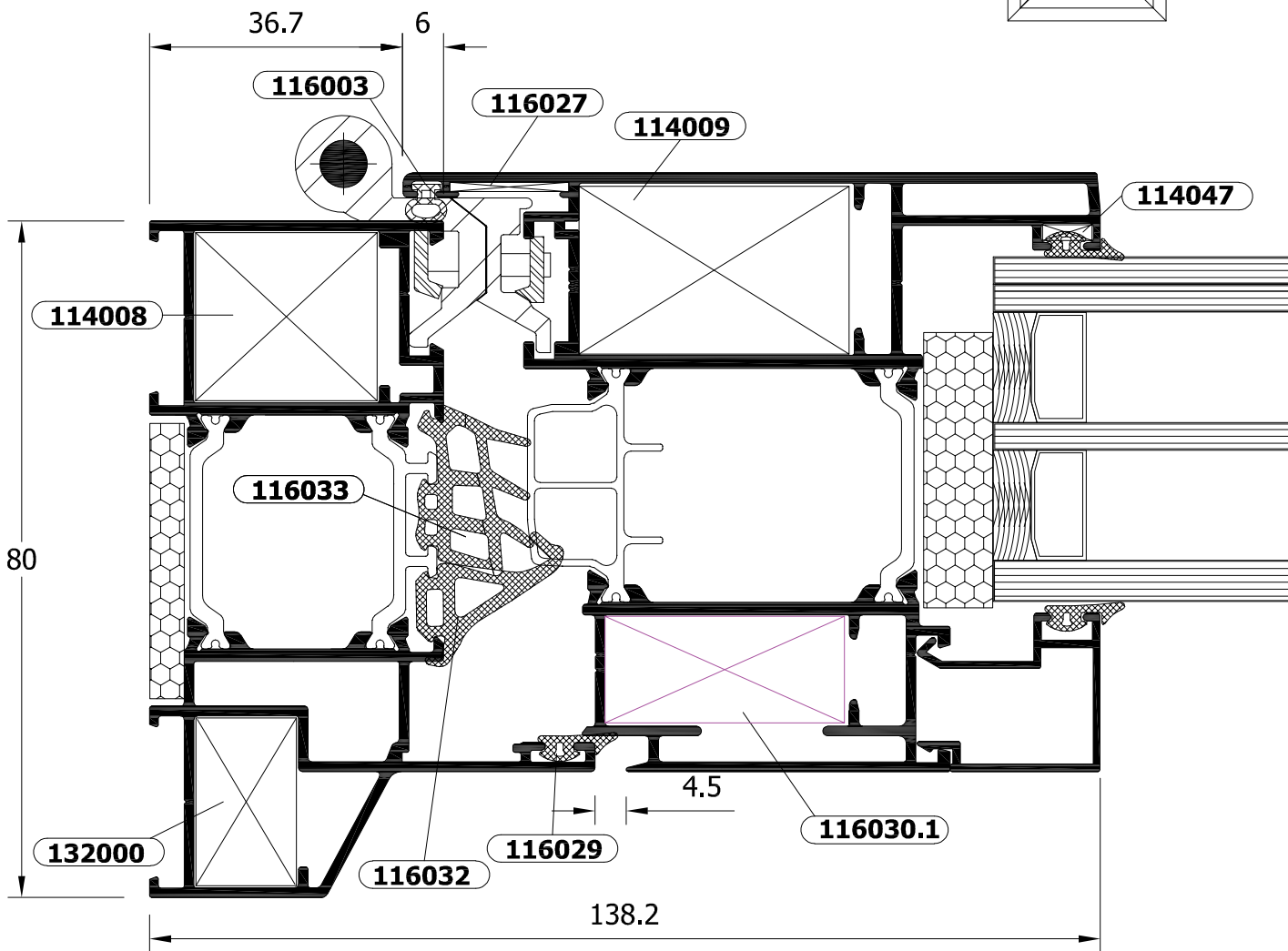
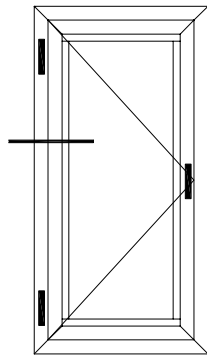

LW

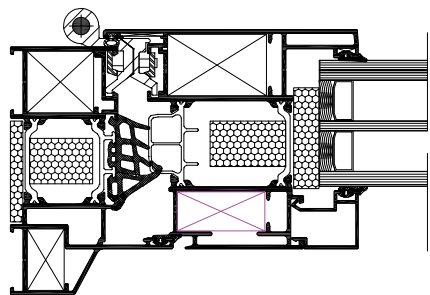

ESCALA 1:3

INVERSOR: **80188**
HOJA: **80193**

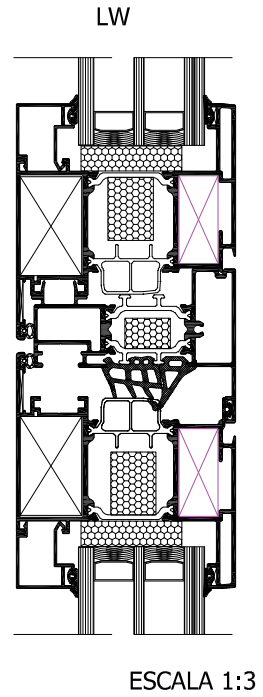
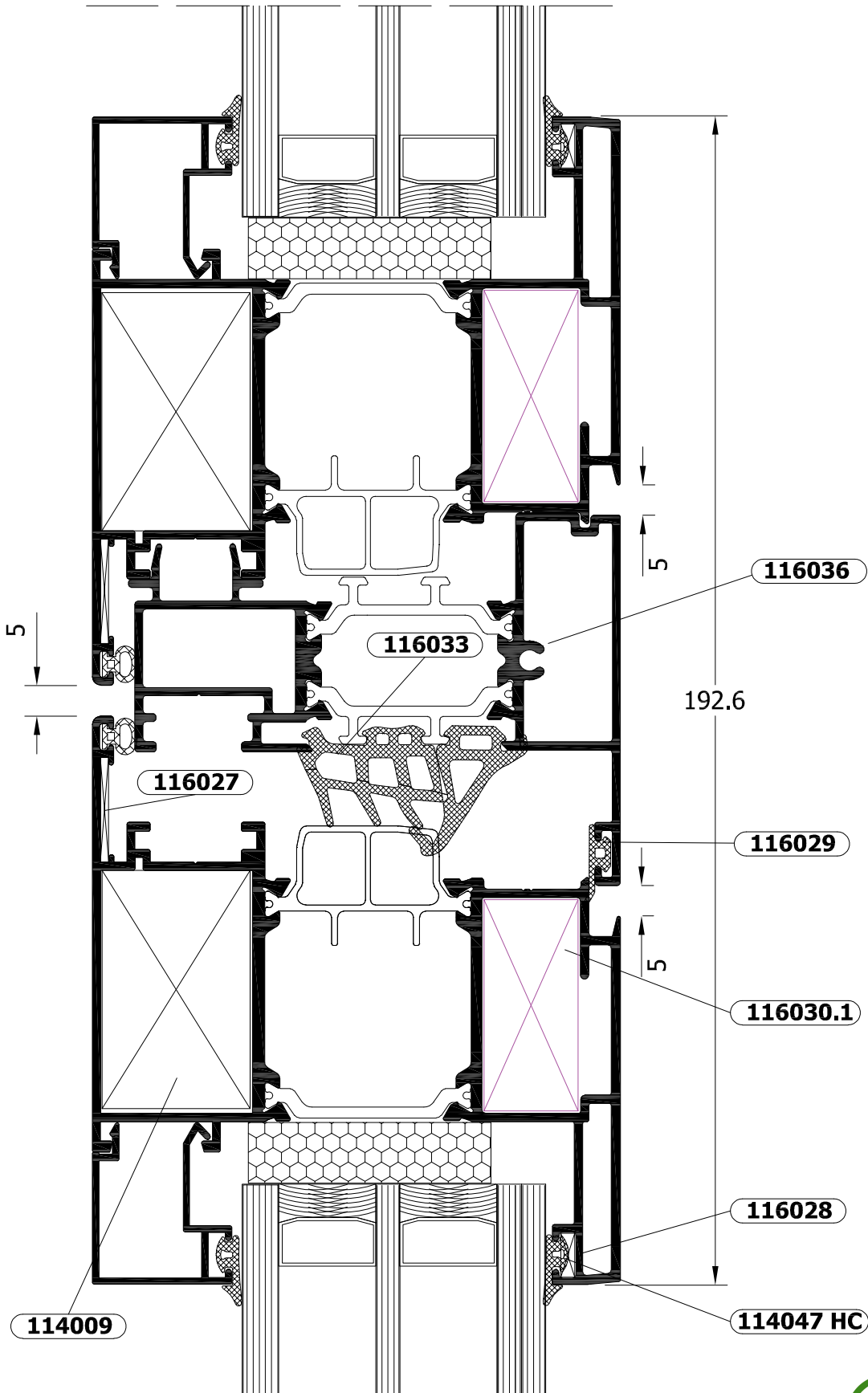
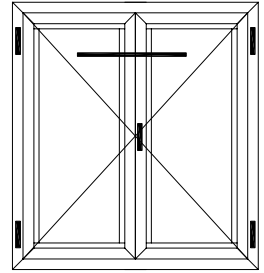

PILASTRA: **80186**
HOJA: **80193**

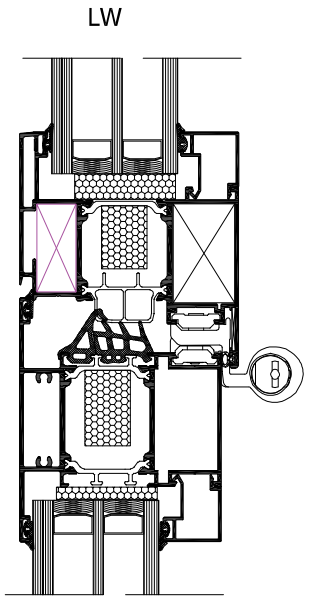
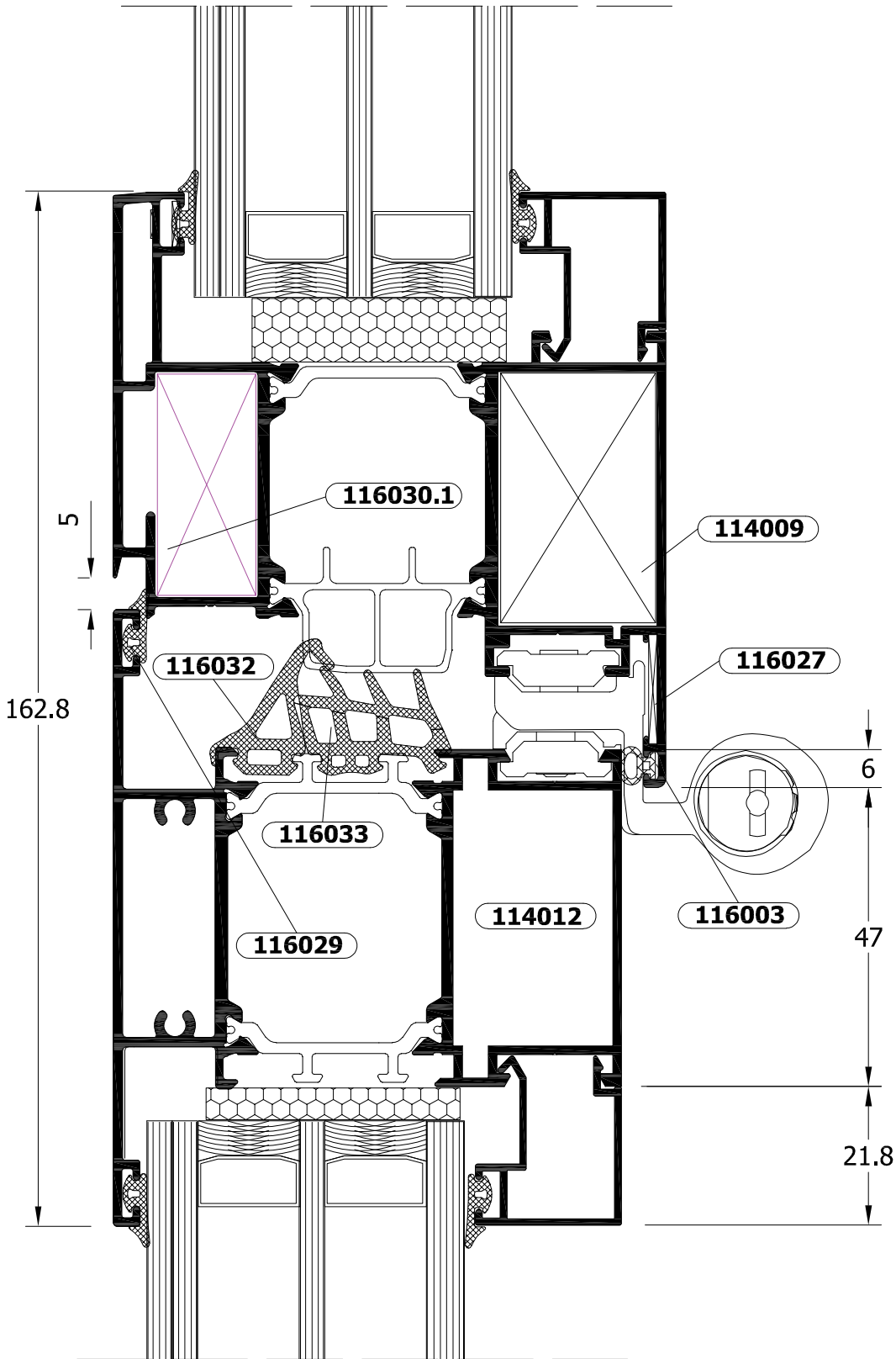
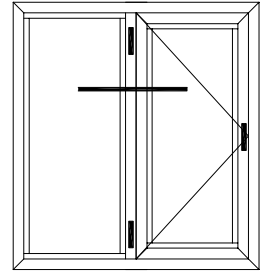

ESCALA 1:3

MARCO: **80191**
 HOJA: **80193**
 ZOCALO: **80194**

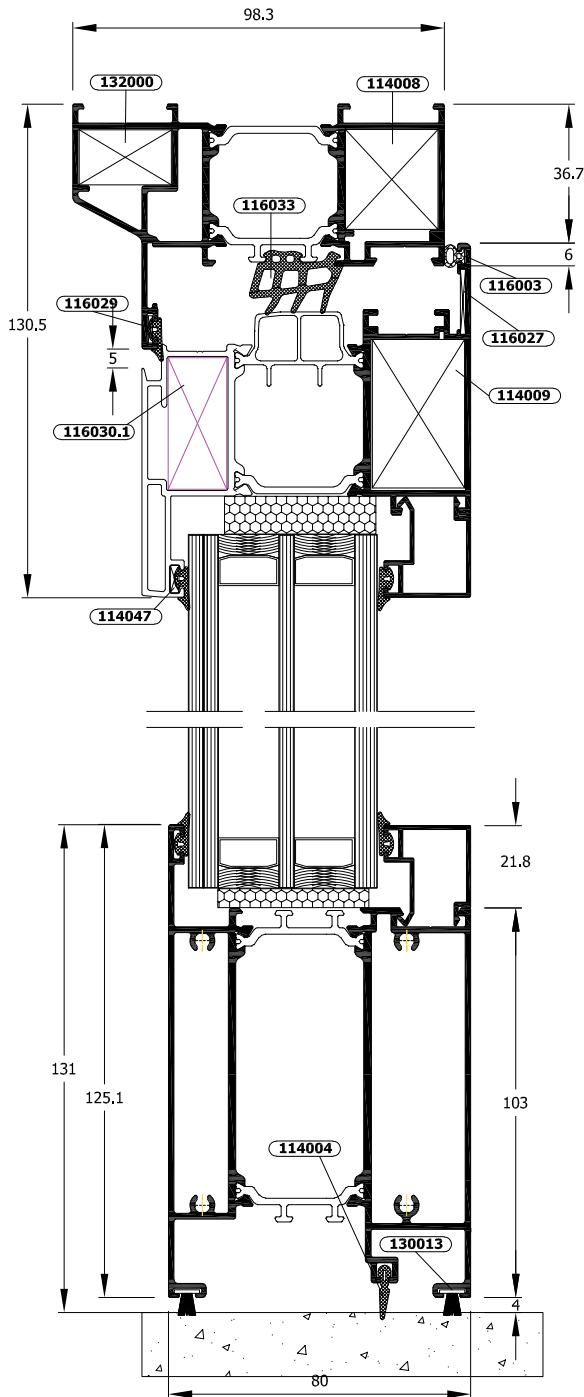
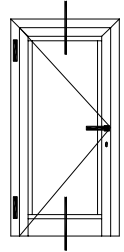

Cerrado

Abierto
(Posibilidad de regulación de 0 11 mm)

Longitud y medida mínima de corte.	
330 mm.	Cortable a 260 mm.
430 mm.	Cortable a 330 mm.
530 mm.	Cortable a 430 mm.
630 mm.	Cortable a 530 mm.
730 mm.	Cortable a 630 mm.
830 mm.	Cortable a 730 mm.
930 mm.	Cortable a 830 mm.
1030 mm.	Cortable a 930 mm.
1130 mm.	Cortable a 1030 mm.
1230 mm.	Cortable a 1130 mm.

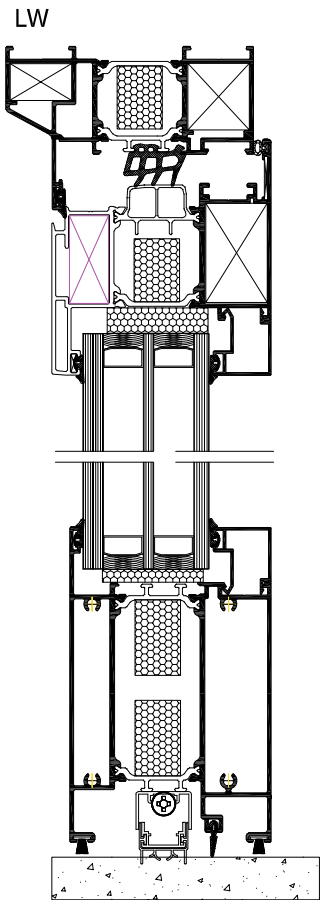

ESCALA 1:2

ESCALA 1:3

- NOTA: Recomendable no colocar la junta central en puertas con cerradura.

MARCO: **80191**
 HOJA: **80193**

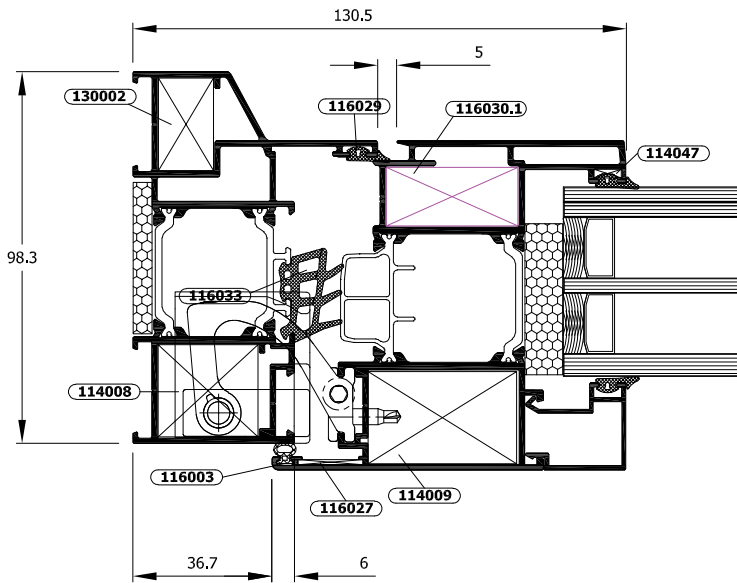
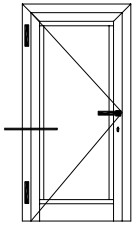

ESCALA 1:2

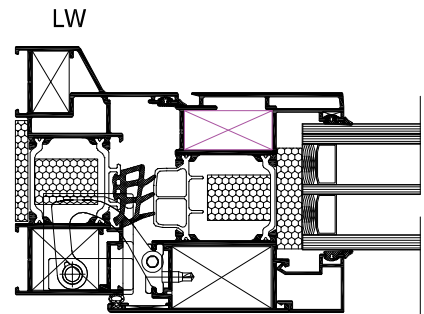

ESCALA 1:3

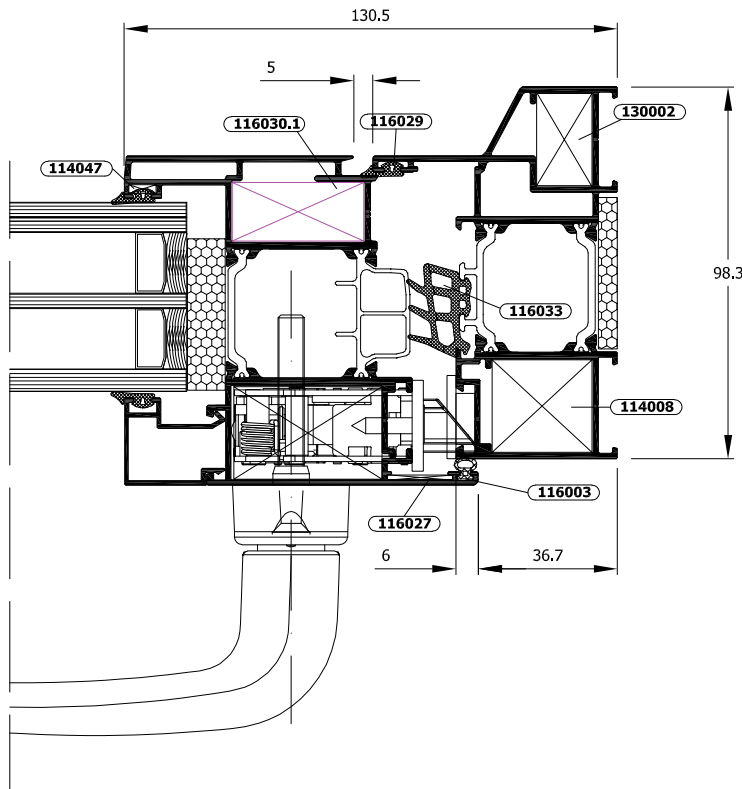

ESCALA 1:2

MARCO: **80191**
 HOJA: **80193**

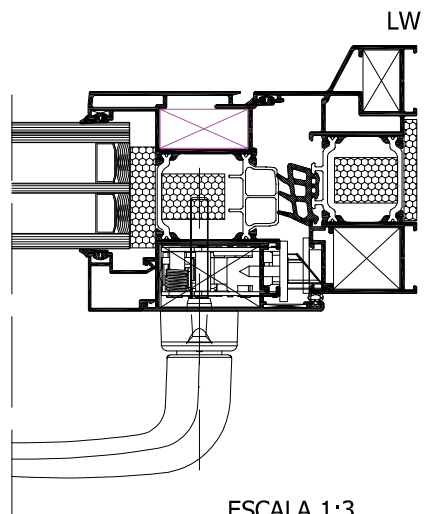
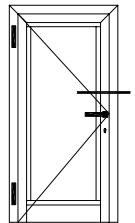

ESCALA 1:3

- NOTA: Recomendable no colocar la junta central en puertas con cerradura.

MARCO: **80191**
 HOJA: **80192**
 ZOCALO: **80194**

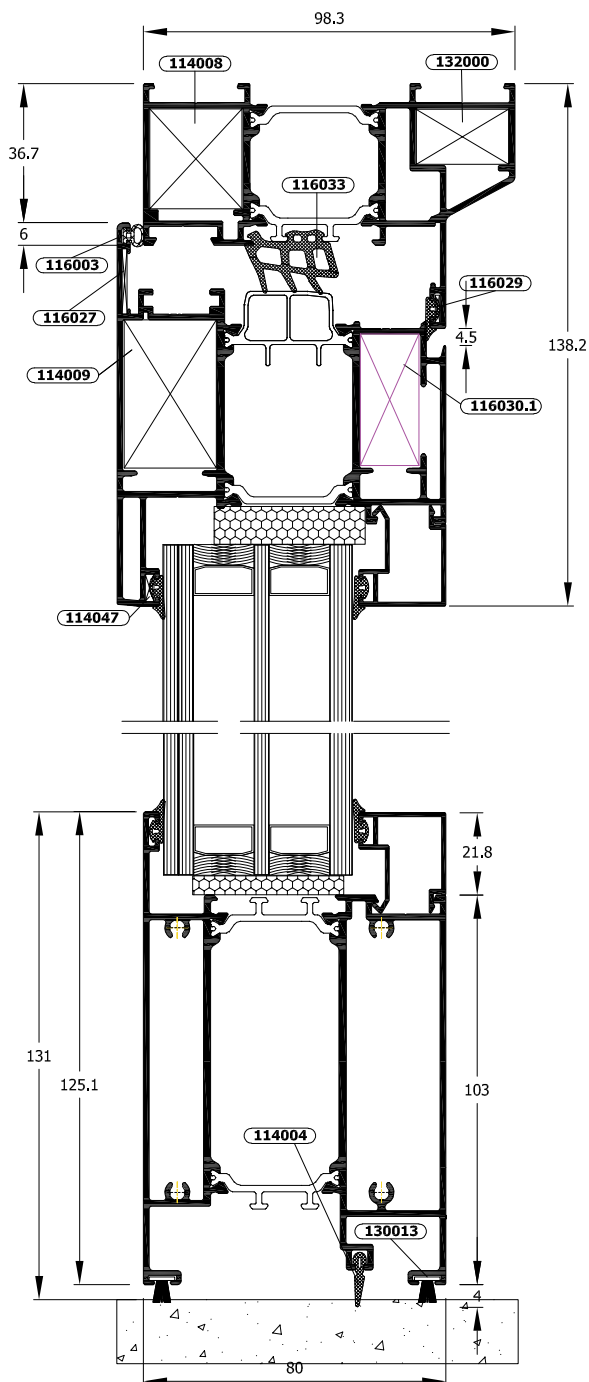
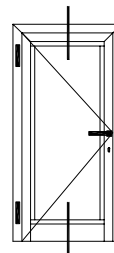

ESCALA 1:2

Cerrado

Abierto
(Posibilidad de regulación de 0 11 mm)

Longitud y medida mínima de corte.	
330 mm.....	Cortable a 280 mm.
430 mm.....	Cortable a 330 mm.
530 mm.....	Cortable a 430 mm.
630 mm.....	Cortable a 530 mm.
730 mm.....	Cortable a 630 mm.
830 mm.....	Cortable a 730 mm.
930 mm.....	Cortable a 830 mm.
1030 mm.....	Cortable a 930 mm.
1130 mm.....	Cortable a 1030 mm.
1230 mm.....	Cortable a 1130 mm.

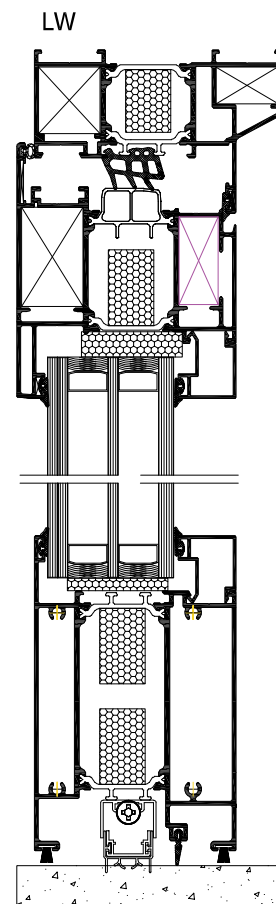

ESCALA 1:3

- NOTA: Recomendable no colocar la junta central en puertas con cerradura.

MARCO: **80191**
 HOJA: **80192**

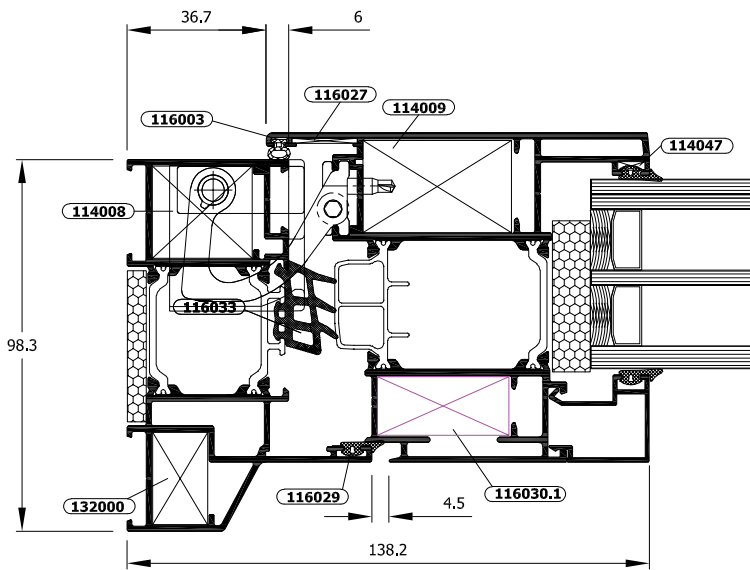
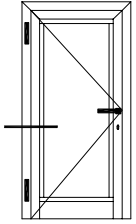

ESCALA 1:2

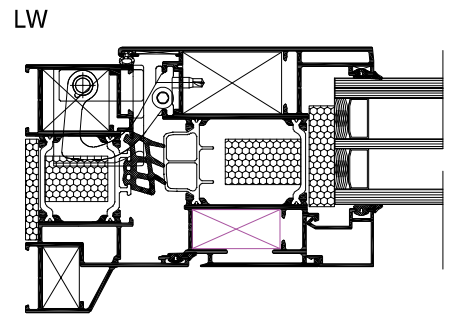

ESCALA 1:3

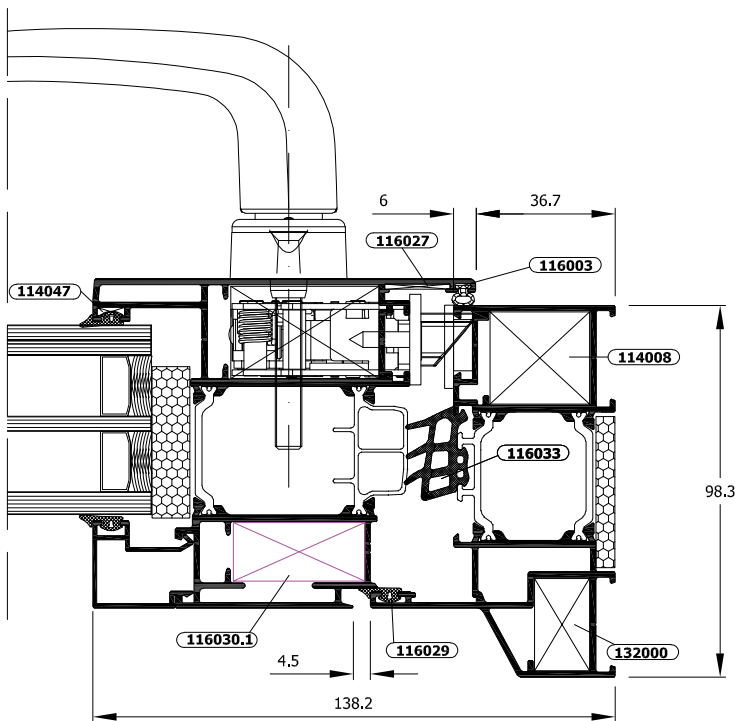

ESCALA 1:2

MARCO: **80191**
 HOJA: **80192**

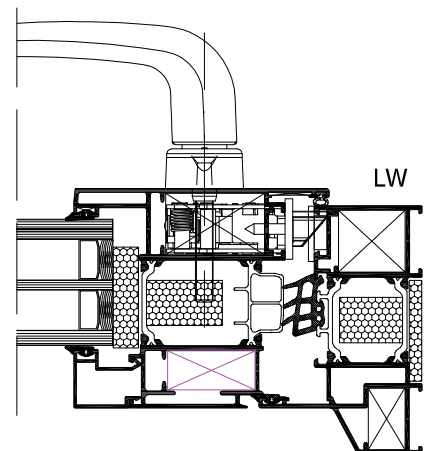
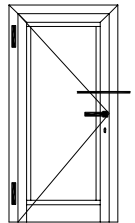

ESCALA 1:3



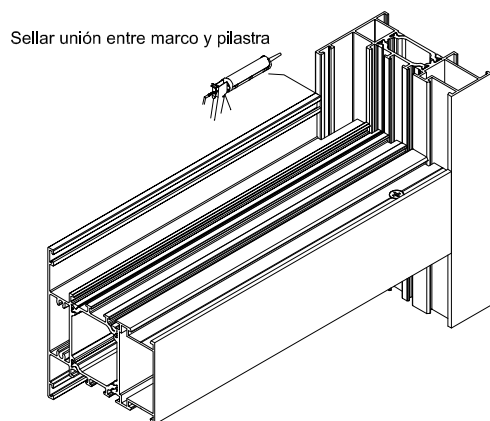
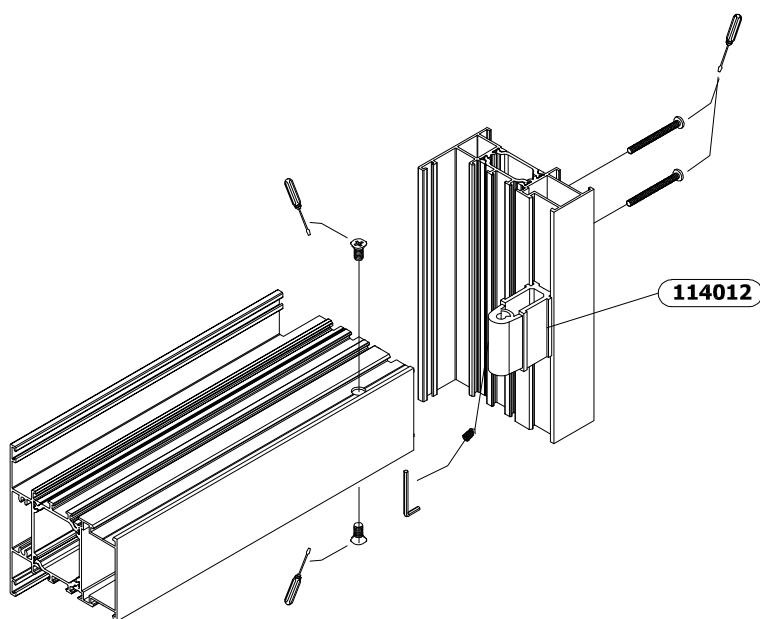
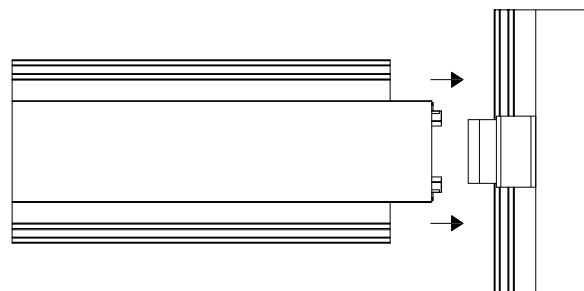
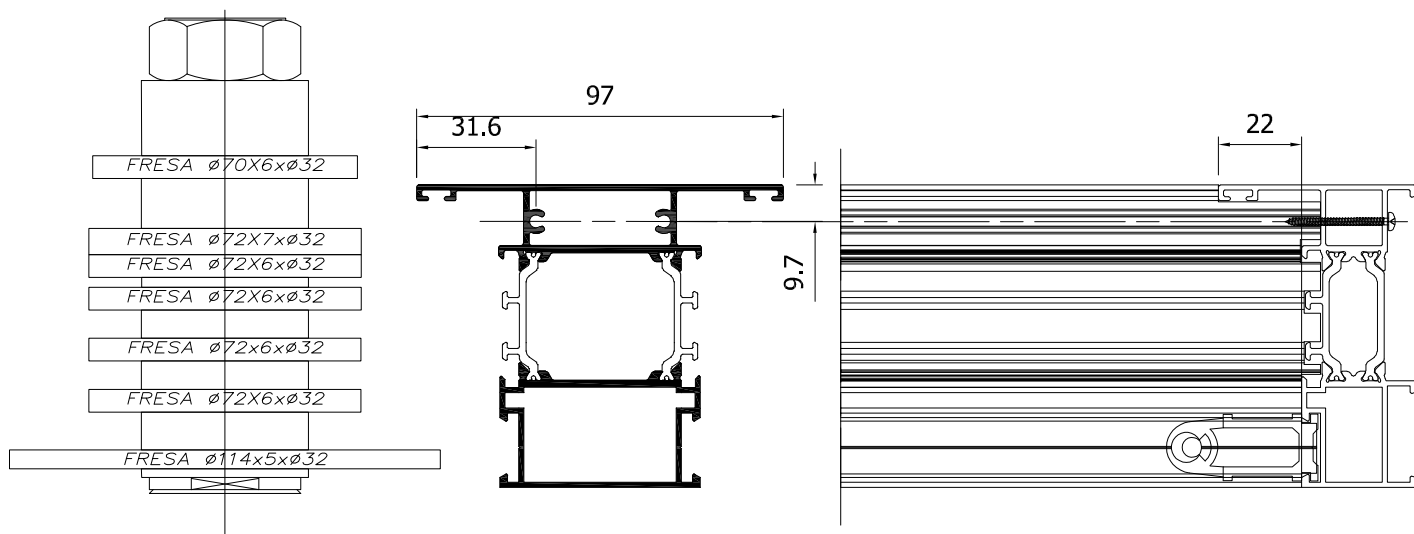

- NOTA: Recomendable no colocar la junta central en puertas con cerradura.



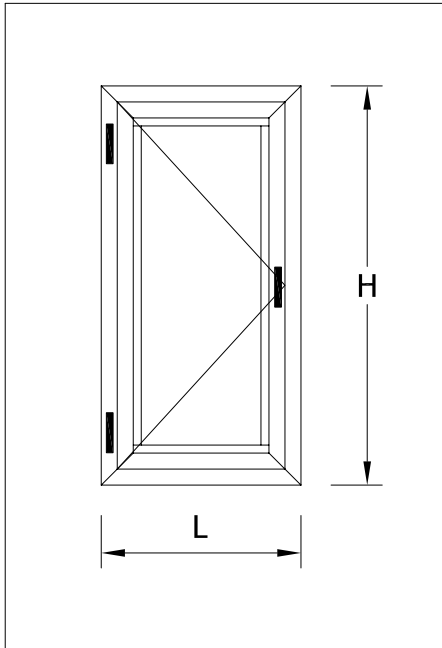

Mecanizado Plastra 80186



MEDIDAS DE CORTE 1 HOJA









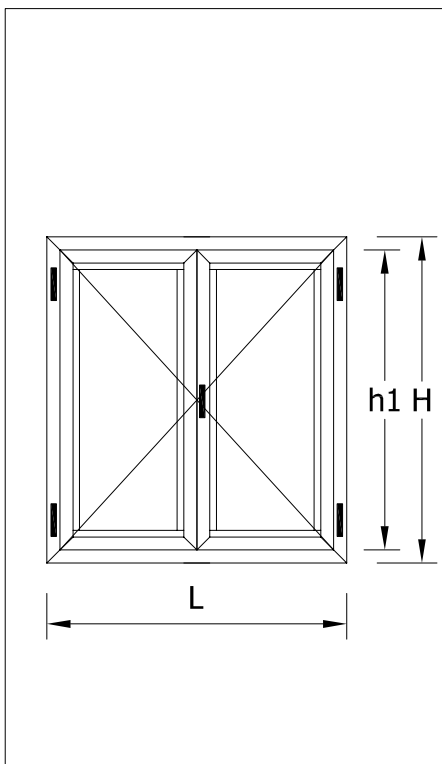







Marco/hoja ventana					
Perfil	Ref.	Descripción	Corte	L	H
	80181	Marco ventana		L	H
	80183	Hoja ventana		L -48	H -48
	13007	Junquillo recto		L-142	H-185'6

Marco ventana/hoja puerta					
Perfil	Ref.	Descripción	Corte	L	H
	80181	Marco ventana		L	H
	80184	Hoja puerta		L -48	H -48
	13007	Junquillo recto		L-191.6	H-235.2

MEDIDAS DE CORTE 2 HOJAS









Marco/hoja ventana					
Perfil	Ref.	Descripción	Corte	L	H
	80181	Marco ventana		L	H
	80183	Hoja ventana		L/2-26'5	H -48
	80188	Inversor			h1-83
	13007	Junquillo recto		L/2-120.5	H-185'6

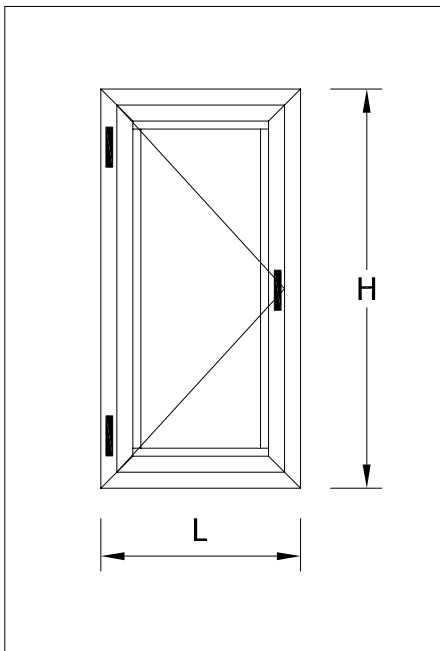



Marco ventana/hoja puerta					
Perfil	Ref.	Descripción	Corte	L	H
	80181	Marco ventana		L	H
	80184	Hoja puerta		L/2-26'5	H -48
	80188	Inversor			h1-83
	13007	Junquillo recto		L/2-170.1	H-235.2

* Se recomienda la verificación de las medidas antes de su fabricación en serie.

MEDIDAS DE CORTE 1 HOJA









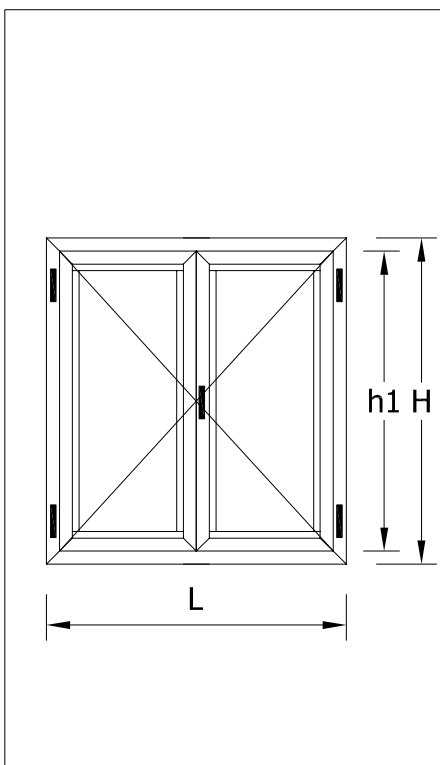







Marco puerta/hoja ventana					
Perfil	Ref.	Descripción	Corte	L	H
	80191	Marco puerta		L	H
	80183	Hoja ventana		L -73.5	H -73.5
	13007	Junquillo recto		L-167.9	H-211.1

Marco puerta/hoja puerta					
Perfil	Ref.	Descripción	Corte	L	H
	80191	Marco puerta		L	H
	80184	Hoja puerta		L -73.5	H -73.5
	13007	Junquillo recto		L-217.1	H-260.6

MEDIDAS DE CORTE 2 HOJAS



Marco puerta/hoja ventana					
Perfil	Ref.	Descripción	Corte	L	H
	80191	Marco puerta		L	H
	80183	Hoja ventana		L/2-26'5	H -73.5
	80188	Inversor			h1-98.5
	13007	Junquillo recto		L/2-133.3	H-211.1

Marco puerta/hoja puerta					
Perfil	Ref.	Descripción	Corte	L	H
	80191	Marco puerta		L	H
	80184	Hoja puerta		L/2-26'5	H -73.5
	80188	Inversor			h1-98.5
	13007	Junquillo recto		L/2-182.8	H-260.6

* Se recomienda la verificación de las medidas antes de su fabricación en serie.

LISTADO ACCESORIO

	Ref.		Ref.
	ACC0 114008 Esc. marco puerta (25 x 27)		ACC0 116003 Goma hoja (Rollo de 300 mt)
	ACC0 114009 Esc. hoja puerta (25 x 40)		ACC0 116032 Junta central (Rollo de 60 mt)
	ACC0 130002 Esc. marco/hoja ventana		ACC0 116033 Junta central (Rollo de 60 mt)
	ACC0 116031 Esc. exterior marco (desplazada)		ACC0 116029 Goma marco ext. EXA (Rollo de 200 mt)
	ACC0 116030 Esc. exterior hoja		ACC0 114004 Junta zócalo
	ACC0 11630.1 Esc. exterior Hoja Puerta Recta		ACC0 130013 Felpudo 7x7
	ACC0 116027 Esc. alineamiento		ACC0 116036 Juego tapón inversor
	ACC0 114047 HC Esc. alineamiento (hoja-exterior)		ACC0 114012 Tocho unión travesaño
	ACC0 116028 Esc. alineamiento hoja		ACC0 110155 Tapa salida de agua



www.aluminiosfranco.es
Murcia 968 271 050
Valencia 961 212 816
Tarragona 977 525 572

alf **aluminios
franco**

